

TRIJENA

STAGE 6 RESERVE

PROJECT NUMBER: 304010

LANDSCAPE ARCHITECTURE DRAWINGS FOR PGG (MICKLEHAM) PTY LTD

To be read in conjunction with specification (304010 L01)

GENERAL NOTES

- Unless otherwise specified on the drawings all measurements, lengths, heights and distances to be determined from dimensions and NOT scaled off the drawings.
- Before commencement of any works it is the responsibility of the Landscape Contractor to contact Dial Before You Dig 1100 (Fax 1300 652 077) for information on services in the area shown on the plan (www.dialbeforeyoudig.com.au)
- The locations of underground services are approximate only and their exact position should be proven on site. No guarantee is given that all existing services are shown. The Contractor shall verify the location and depth of all services prior to commencing on site.
- The Contractor must have a copy of Melbourne One Call/Services information and plans on site at all times.
- The Contractor shall be liable for any damage to services during landscape works.
- All trees shall be planted in locations shown on this plan, with setout to be approved on site by the Superintendent prior to planting.
- Tree canopies are shown at 75% of mature diameter.
- Any change in plant species must have the approval of the Superintendent.
- Trees shall not be planted less than the following distances from existing elements, unless otherwise stated in the documentation:
 - ~ Pedestrian pathways - 1.2m
 - ~ Pedestrian pathways in reserve - 2.0m
 - ~ Driveways and crossovers - 3.0m
 - ~ Stormwater and sewerage pits - 2.0m
 - ~ Intersections - 10.0m
 - ~ Service crossings - 2.0m
 - ~ Back of Kerb - 1.0m min.
 - ~ Street lights and power poles - 4.0m
 - ~ Service assets, including junction boxes, pits etc - 2.0m
 - ~ Fire plugs - 3.0m
- The Superintendent is to inspect trees supplied by the Contractor prior to planting.
- The Principal will ensure that all property boundaries are to be pegged out by licensed surveyors prior to set out of landscape works.
- All drawings 'For Construction' to be printed in colour

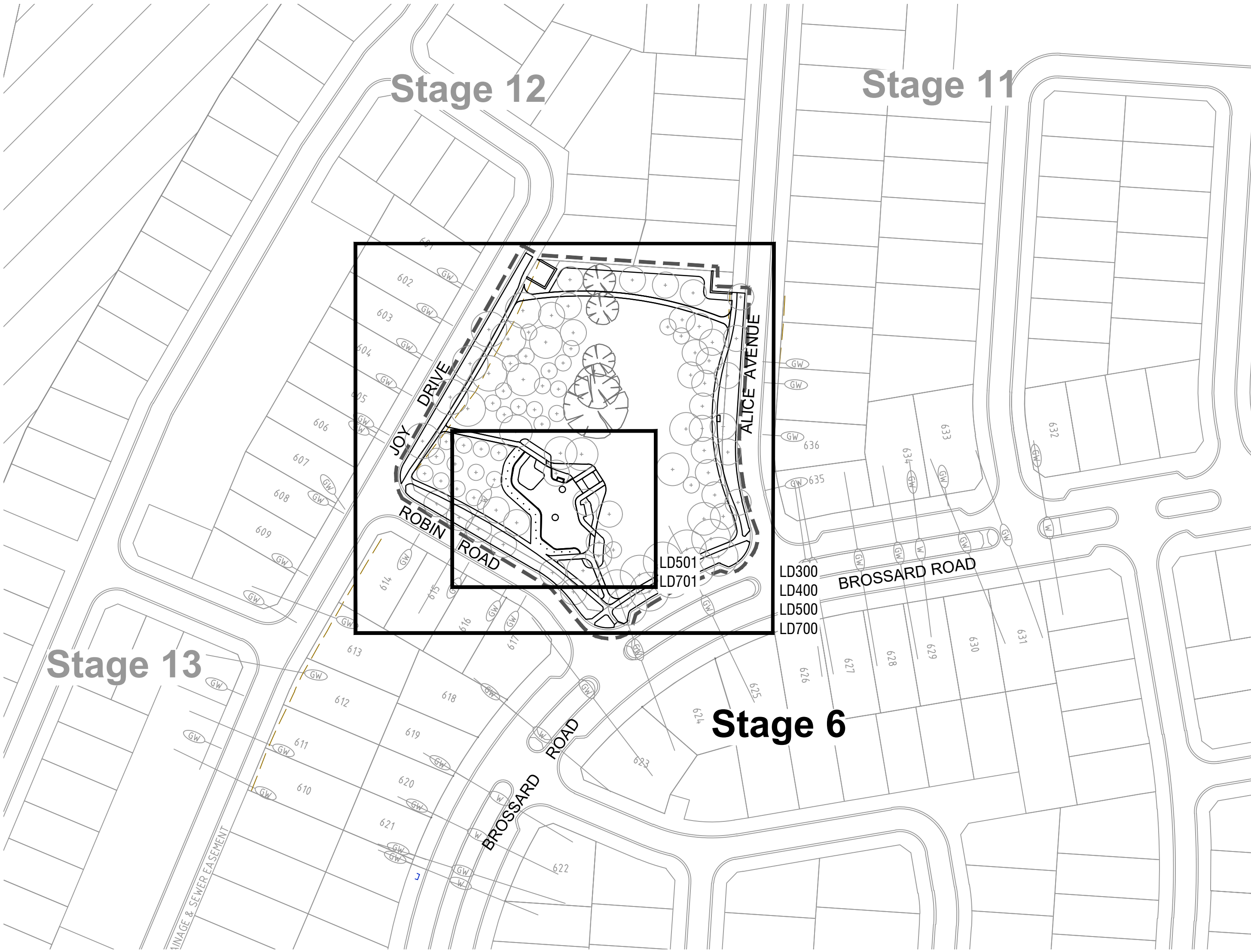

1 EXTENT OF WORKS AND KEY PLAN
LD100 Scale 1:1000 @ A1

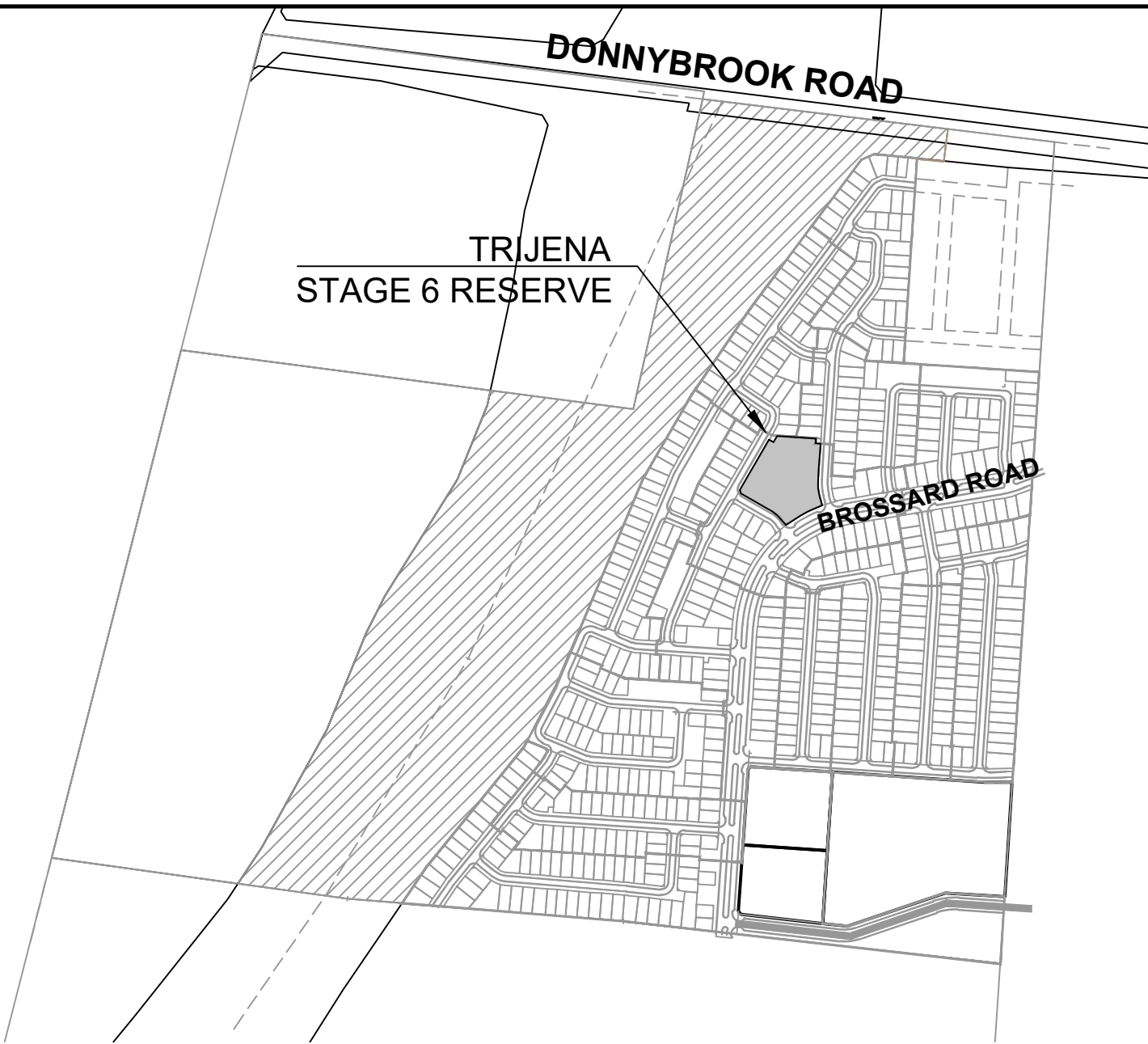

2 SITE LOCATION
LD100 Scale 1:7500 @ A1

DRAWING SCHEDULE

REFERENCE	DESCRIPTION	REVISION	SHEET No.
304010LD100	COVER SHEET	D	1
304010LD200	MATERIALS + PLANTING SCHEDULES	D	2
304010LD300	GENERAL ARRANGEMENT PLAN	D	3
304010LD400	GRADING PLAN	D	4
304010LD500	SURFACES & FINISHES PLAN	D	5
304010LD501	DETAIL PLAN	D	6
304010LD700	TREE PLAN	D	7
304010LD701	PLANTING PLAN	D	8
304010LD900	DETAILS SHEET 1	D	9
304010LD901	DETAILS SHEET 2	D	10
304010LD902	DETAILS SHEET 3	D	11
304010LD903	DETAILS SHEET 4	D	12
304010LD904	DETAILS SHEET 5	D	13
304010LD905	DETAILS SHEET 6	D	14
304010LD906	DETAILS SHEET 7	D	15

D	AMENDED IN ACCORDANCE WITH COUNCIL COMMENTS	MB	18-02-20	
C	AMENDED IN ACCORDANCE WITH COUNCIL COMMENTS	SR	23-07-19	
B	ISSUED FOR APPROVAL TO COUNCIL	S.R	13-06-19	
A	PRELIMINARY ISSUE	SR	12-06-19	
Rev	Amendments	Approved	Date	

H 1:1000
SCALE @ A1

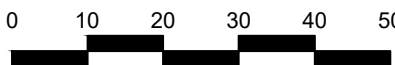

© Spiire Australia Pty Ltd All Rights Reserved
This document is produced by Spiire Australia Pty Ltd solely for the benefit of and use by the client in accordance with the terms of the retainer. Spiire Australia Pty Ltd does not and shall not assume any responsibility or liability whatsoever to any third party arising out of any use or reliance by third party on the content of this document.

spiire

414 La Trobe Street PO Box 16084 Melbourne
Victoria 8007 Australia T 61 3 9993 7888
spiire.com.au ABN 55 050 029 635

Designed
M.W
Authorised
S.R

Checked
T.S
Date
13-06-19

**TRIJENA
STAGE 6 RESERVE
COVER SHEET**

HUME CITY COUNCIL
PGG (MICKLEHAM) PTY LTD

PRELIMINARY Drg No
304010LD100

Rev
D

PLANTING SCHEDULE

BUFFER PLANTING: 150mm Pots				Planting Code	P1	P2	P3	P4	P5	P6	P7	P8	P9	P10	P11	P12	P13	P14	P15	P16	P17	P18			
				Area m2	3.00	1.00	4.00	2.00	6.00	3.00	3.00	7.00	3.00	4.00	4.00	2.00	4.00	2.00	2.00	4.00	3.00	3.00			
BOTANICAL NAME		COMMON NAME	SPECIES DENSITY m2	% DISTRIBUTION SPECIES																			TOTAL NO. OF PLANTS		
	Cotyledon orbiculata 'Silver Dust'	Silver Dust	2	100%																		6	6		
	Eremophila 'Silver Ball'	Emu Bush	2	100%								14											14		
	Hylotehium spectabile 'Autumn Joy'	Sedum 'Automn Joy'	3	100%		3											6						9		
	Kniphofia hybrid Poco Yellow	Dwarf Red Hot Poker	3	100%						9													9		
	Leucadendron salignum	Devils Blush	3	100%											12				12				24		
	Lomandra longifolia	Long John Silver	4	100%					24					16							12		60		
	Myoporum parvifolium 'Purpurea'	Creeping Boobialla	1	100%	3								3						8				6		
	Stachys byzantina 'Big Ears'	Lamb's Ears 'Big Ears'	3	100%			12									6							18		
	Westringia fruticosa 'Flat n Fruity'	Coastal Rosemary	2	100%				4				6					8						18		
																							164		
BUFFER PLANTING: 150mm Pots				Planting Code	P19	P20	P21	P22	P23	P24	P25	P26	P27	P28	P29	P30	P31	P32	P33	P34	P35	P36	P37		
				Area m2	3.00	2.00	6.00	5.00	4.00	3.00	6.00	6.00	4.00	2.00	7.00	1.00	4.00	2.00	3.00	5.00	2.00	6.00	6.00		
BOTANICAL NAME		COMMON NAME	SPECIES DENSITY m2	% DISTRIBUTION SPECIES																			TOTAL NO. OF PLANTS		
	Cotyledon orbiculata 'Silver Dust'	Silver Dust	2	100%										4							4		8		
	Eremophila 'Silver Ball'	Emu Bush	2	100%			12								14								26		
	Hylotehium spectabile 'Autumn Joy'	Sedum 'Automn Joy'	3	100%		6										3							9		
	Kniphofia hybrid Poco Yellow	Dwarf Red Hot Poker	4	100%					16			24											40		
	Leucadendron salignum	Devils Blush	3	100%															15				15		
	Lomandra longifolia	Long John Silver	4	100%							24		16					8			24		72		
	Myoporum parvifolium 'Purpurea'	Creeping Boobialla	1	100%																			0		
	Stachys byzantina 'Big Ears'	Lamb's Ears 'Big Ears'	3	100%	9					9							12						30		
	Westringia fruticosa 'Flat n Fruity'	Coastal Rosemary	2	100%				10										6				12	28		
																							228		

NODAL POINT PLANTING: 150mm Pots				Planting Code	P38	P39	P40	P41	P42	P43	P44	P45	P46	P47	P48	P49	P50	P51		
				Area m2	9.00	2.00	7.00	2.00	3.00	4.00	3.00	9.00	6.00	2.00	3.00	2.00	3.00	3.00		
BOTANICAL NAME		COMMON NAME	SPECIES DENSITY m2	% DISTRIBUTION SPECIES																TOTAL NO. OF PLANTS
Acacia acinaea		Gold Dust Wattle	1	100%			7													7
Eremophila 'Silver Ball'		Emu Bush	2	100%								18								18
Kniphofia hybrid Poco Yellow		Dwarf Red Hot Poker	4	100%										8						8
Leucadendron salignum		Devils Blush	3	100%																0
Lomandra longifolia		Long John Silver	4	100%	36			8	12				24							80
Myoporum parvifolium 'Purpurea'		Creeping Boobialla	1	100%						4					3		3			10
Stachys byzantina 'Big Ears'		Lamb's Ears 'Big Ears'	3	100%												6		9		15
Westringia fruticosa 'Flat n Fruity'		Coastal Rosemary	2	100%		4					6									10
																				148
SEAT NODE PLANTING: 150mm Pots				Planting Code	P52	P53	P54	P55	P56	P57										
				Area m2	7.00	8.00	4.00	3.00	6.00	5.00										
BOTANICAL NAME		COMMON NAME	SPECIES DENSITY m2	% DISTRIBUTION SPECIES							TOTAL NO. OF PLANTS									
Acacia cognata		River Wattle	1	100%		8			6		14									
Stachys byzantina 'Big Ears'		Lamb's Ears 'Big Ears'	3	100%	21		12	9		15	57									
											71									

NORTHERN BOUNDARY PLANTING: 150mm Pots				Planting Code	P58	
				Area m2	162.00	
BOTANICAL NAME		COMMON NAME	SPECIES DENSITY m2	% DISTRIBUTION SPECIES		TOTAL NO. OF PLANTS
Callistemon 'Kings Park Special'		Kings Park Special Bottlebrush	1.2	100%	194	194
RESERVE TREES						
CODE	BOTANICAL NAME	COMMON NAME	MATURE SIZE HxW	INSTALLATION SIZE	TOTAL QUANTITY	
Ah	Angophora hispida	Dwarf Apple	5 x 6m	min 2.5m tall, 30mmØ	19	
Cc	Corymbia citriodora	Lemon-scented Gum	12x8m	min 2.5m tall, 30mmØ	14	
Cm	Corymbia maculata	Spotted Gum	30x10	min 2.5m tall, 30mmØ	9	
Em	Eucalyptus Leucoxylon 'Megalocarpa'	Yellow Gum	12x7	min 2.5m tall, 30mmØ	23	
Pn	Pyrus nivalis	Snow Pear	8x5m	min 2.5m tall, 30mmØ	12	
Qc	Quercus ceris	Turkey Oak	7x15	min 2.5m tall, 30mmØ	8	
Qco	Quercus coccinea	Scarlet Oak	12x8m	min 2.5m tall, 30mmØ	2	
Up	Ulmus parvifolia 'Todd'	Chinese Elm	15 x 6m	min 2.5m tall, 30mmØ	10	
				Total Trees	97	

file name 304010 Reserve L01.dwg, layout name L0200, plotted by Matthew Bradbury, file location \\spire.com.au\media\A\01\304010\landscape\product\plot date 26/02/2020 10:17 AM Sheet 2 of 15 Sheets

D	AMENDED IN ACCORDANCE WITH COUNCIL COMMENTS	MB	18-02-20	
C	AMENDED IN ACCORDANCE WITH COUNCIL COMMENTS	SR	23-07-19	
B	ISSUED FOR APPROVAL TO COUNCIL	S.R	13-06-19	
A	PRELIMINARY ISSUE	SR	12-06-19	
Rev	Amendments	Approved	Date	

AS SHOWN



© Spiire Australia Pty Ltd All Rights Reserved
This document is produced by Spiire Australia Pty Ltd solely for the benefit of and use by the client in accordance with the terms of the retainer. Spiire Australia Pty Ltd does not and shall not assume any responsibility or liability whatsoever to any third party arising out of any use or reliance by third party on the content of this document.



414 La Trobe Street PO Box 16084 Melbourne
Victoria 8007 Australia T 61 3 9993 7888
spiire.com.au ABN 55 050 029 635

Designed
M.W
Authorised
S.R

Checked
T.S
Date
13-06-19

TRIJENA
STAGE 6 RESERVE
SCHEDULES
MATERIALS & PLANTING
HUME CITY COUNCIL
PGG (MICKLEHAM) PTY LTD

PRELIMINARY Drg No 304010LD200

Rev
D

file name: 304010 Reserve LD01.dwg, layout name: LD0300, plotted by: Matthew Bradbury, file location: \\spire.com.au\unshared\LD0300\30401000\landscape\product\plot date: 26/02/2020 10:17 AM Sheet: 3 of 15 Sheets

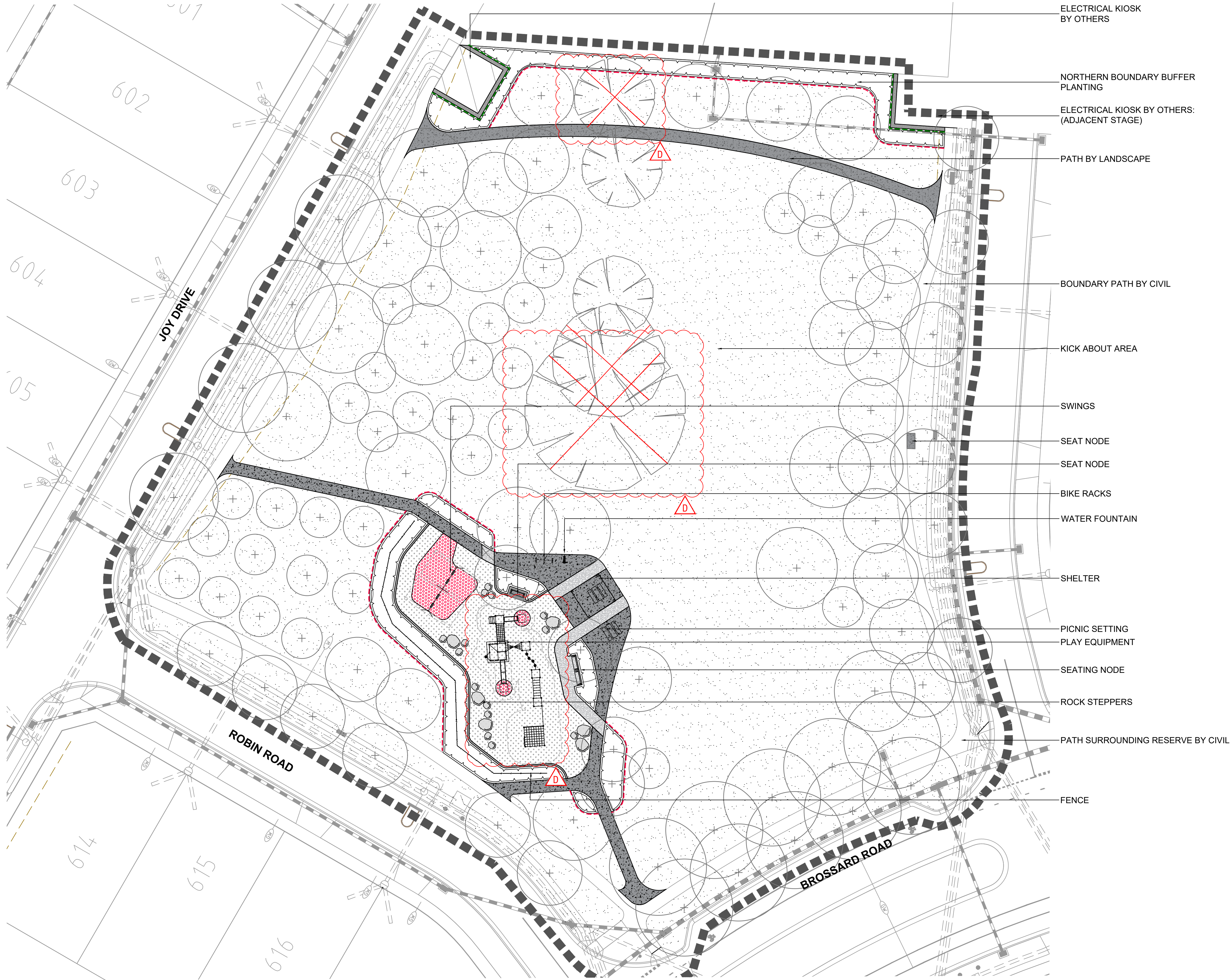

- LEGEND
- Proposed Tree
As scheduled, detailed and specified 1/LD902
- Tree to be retained
As scheduled, detailed and specified
- Tree to be removed
Refer Arborist's report
- Turf Grass
As scheduled, detailed and specified 3/LD902
- Proposed Garden Bed
Refer to planting schedule 4/LD902
- Plain Grey Concrete
As scheduled, detailed and specified 1/LD900
- Sand Blasted Concrete: Type 1
As scheduled, detailed and specified 1/LD900
- Compacted Gravel
As scheduled, detailed and specified 2/LD900
- Proposed Softfall Mulch
As scheduled, detailed and specified 1/LD901
- Proposed Softfall Rubber
As scheduled, detailed and specified 2/LD901
- Concrete Edge
As scheduled, detailed and specified 4/LD900
- Steel Edge
As scheduled, detailed and specified 6/LD900
- Spade Edge
As scheduled, detailed and specified 7/LD900
- Fence
As scheduled and specified
- Boulders
As scheduled, detailed and specified 4/LD901
- Shelter and Picnic Setting
As scheduled, detailed and specified 1/LD906
- Seat Node
As scheduled, detailed and specified 1/LD905
- Bike Rack
As scheduled, detailed and specified 1/LD904
- Water Fountain
As scheduled, detailed and specified 2/LD904
- Modular Rope Climbing Structure
As scheduled, detailed and specified
- Community Swing
As scheduled, detailed and specified 1/LD903
- Existing Underground Services
By others
- Street lights
By others

D	AMENDED IN ACCORDANCE WITH COUNCIL COMMENTS	MB	18-02-20	
C	AMENDED IN ACCORDANCE WITH COUNCIL COMMENTS	SR	23-07-19	
B	ISSUED FOR APPROVAL TO COUNCIL	S.R	13-06-19	
A	PRELIMINARY ISSUE	SR	12-06-19	
Rev	Amendments	Approved	Date	

H: 1:250
SCALE @ A1

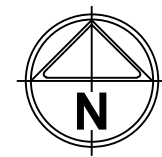

© Spiire Australia Pty Ltd All Rights Reserved
This document is produced by Spiire Australia Pty Ltd solely for the benefit of and use by the client in accordance with the terms of the retainer. Spiire Australia Pty Ltd does not and shall not assume any responsibility or liability whatsoever to any third party arising out of any use or reliance by third party on the content of this document.



414 La Trobe Street PO Box 16084 Melbourne
Victoria 8007 Australia T 61 3 9993 7888
spiire.com.au ABN 55 050 029 635

Designed M.W	Checked T.S
Authorised S.R	Date 13-06-19

TRIJENA
STAGE 6 RESERVE
GENERAL ARRANGEMENT PLAN

HUME CITY COUNCIL
PGG (MICKLEHAM) PTY LTD

PRELIMINARY

Drg No
304010LD300

Rev
D

file name 304010 Reserve LD01.dwg, layout name LD01.00, plotted by Matthew Bradbury, file location \\spire.com.au\united\data\304010\landscape\product\plot date 26/02/2020 10:17 AM Sheet 4 of 15 Sheets

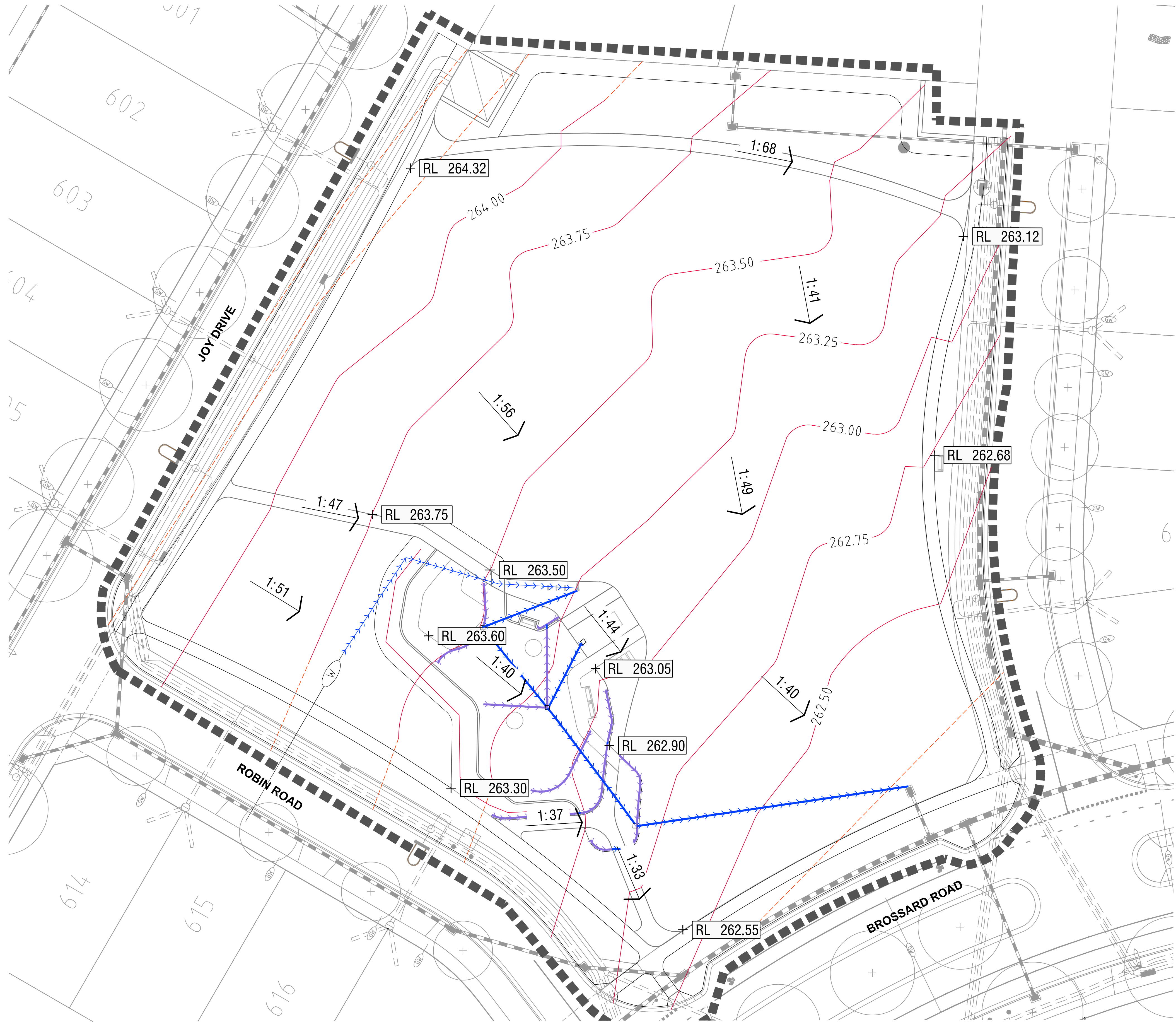

LEGEND

- Existing Contour 0.25 intervals
- Proposed Contour 0.25 intervals
- Drainage Ag Pipe
- Drainage PVC Pipe
- Drainage Junction Pit
- Relative Level
- Proposed Slope
- Existing Underground Services
By others
- Street lights
By others
- Extent of Works

NOTE:

- CONTRACTOR TO ENDURE POSITIVE DRAINING THROUGHOUT THE SITE

D	AMENDED IN ACCORDANCE WITH COUNCIL COMMENTS	MB	18-02-20	
C	AMENDED IN ACCORDANCE WITH COUNCIL COMMENTS	SR	23-07-19	
B	ISSUED FOR APPROVAL TO COUNCIL	S.R	13-06-19	
A	PRELIMINARY ISSUE	SR	12-06-19	
Rev	Amendments	Approved	Date	

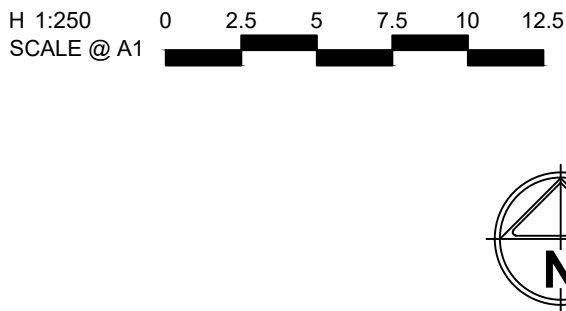

© Spiire Australia Pty Ltd All Rights Reserved
This document is produced by Spiire Australia Pty Ltd solely for the benefit of and use by the client in accordance with the terms of the retainer. Spiire Australia Pty Ltd does not and shall not assume any responsibility or liability whatsoever to any third party arising out of any use or reliance by third party on the content of this document.

414 La Trobe Street PO Box 16084 Melbourne
Victoria 8007 Australia T 61 3 9993 7888
spiire.com.au ABN 55 050 029 635

Designed	Checked
M.W	T.S
Authorised	Date
S.R	13-06-19

TRIJENA
STAGE 6 RESERVE
GRADING AND DRAINAGE PLAN

HUME CITY COUNCIL
PGG (MICKLEHAM) PTY LTD

PRELIMINARY

Drg No
304010LD400

Rev
D

file name 304010 Reserve L001.dwg, layout name L000, plotted by Matthew Bradbury, file location \\spire.com.au\united\au\data\304010\landscape\product\plot date 26/02/2020 10:17 AM Sheet 5 of 15 Sheets

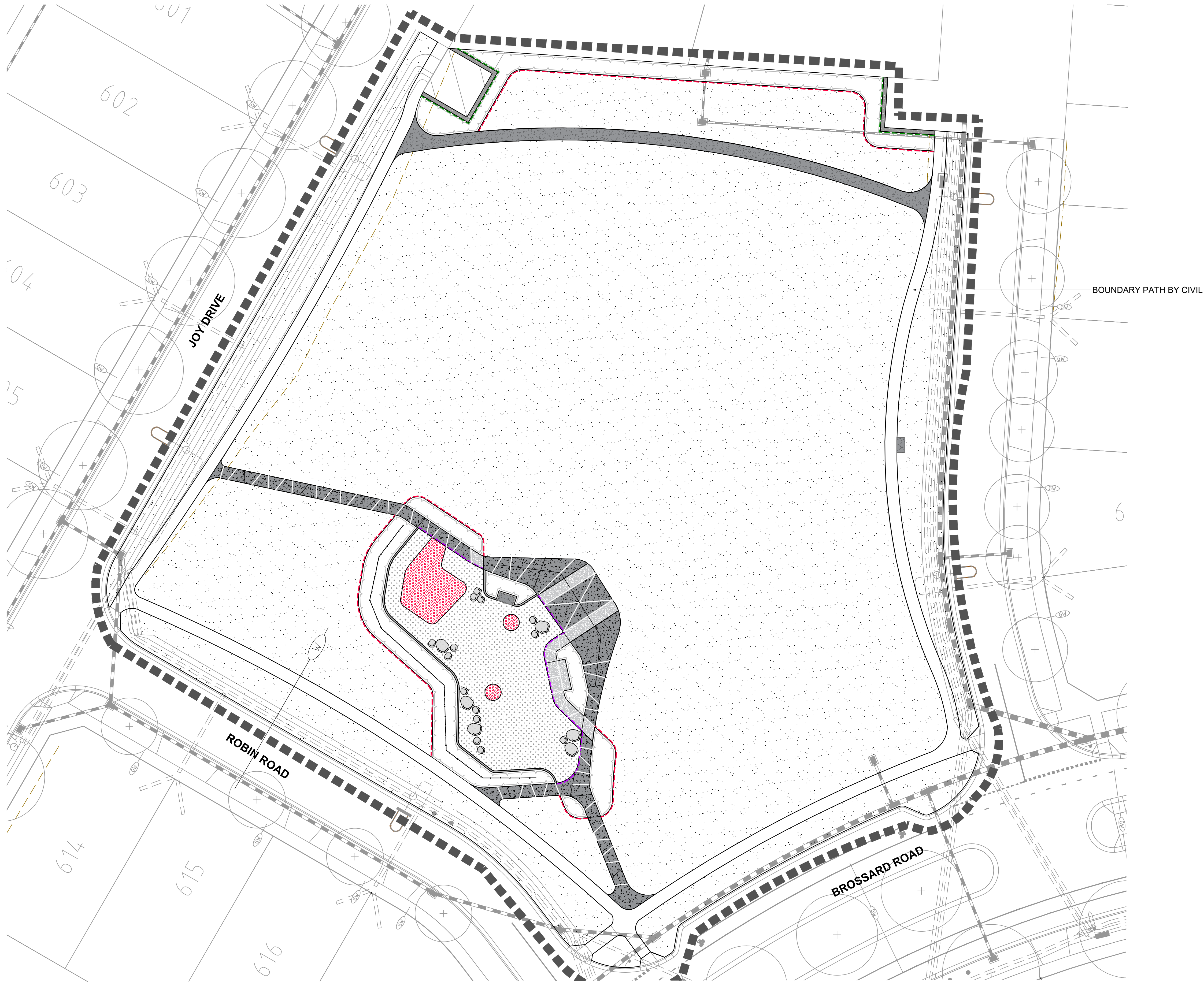

LEGEND

- Turf Grass**
As scheduled, detailed and specified 3/LD902
- Proposed Garden Bed**
Refer to planting schedule 4/LD902
- Plain Grey Concrete**
As scheduled, detailed and specified 1/LD900
- Sand Blasted Concrete: Type 1**
As scheduled, detailed and specified 1/LD900
- Compacted Gravel**
As scheduled, detailed and specified 2/LD900
- Proposed Softfall Mulch**
As scheduled, detailed and specified 1/LD901
- Proposed Softfall Rubber**
As scheduled, detailed and specified 2/LD901
- Concrete Edge**
As scheduled, detailed and specified 4/LD900
- Spade Edge**
As scheduled, detailed and specified 7/LD900
- Steel Edge**
As scheduled, detailed and specified 6/LD900
- Thickend Concrete Edge**
As scheduled, detailed and specified 5/LD900
- Expansion Joints**
As scheduled, detailed and specified 3/LD900
- Saw Cuts**
As scheduled, detailed and specified 3/LD900
- Fence**
As scheduled and specified
- Boulders**
As scheduled, detailed and specified 4/LD901
- Existing Underground Services**
By others
- Street lights**
By others
- Extent of Works**

Rev	Amendments	Approved	Date
D	AMENDED IN ACCORDANCE WITH COUNCIL COMMENTS	MB	18-02-20
C	AMENDED IN ACCORDANCE WITH COUNCIL COMMENTS	SR	23-07-19
B	ISSUED FOR APPROVAL TO COUNCIL	S.R	13-06-19
A	PRELIMINARY ISSUE	SR	12-06-19

H: 1:250
SCALE @ A1



© Spiire Australia Pty Ltd All Rights Reserved
This document is produced by Spiire Australia Pty Ltd solely for the benefit of and use by the client in accordance with the terms of the retainer. Spiire Australia Pty Ltd does not and shall not assume any responsibility or liability whatsoever to any third party arising out of any use or reliance by third party on the content of this document.

spiire

414 La Trobe Street PO Box 16084 Melbourne
Victoria 8007 Australia T 61 3 9993 7888
spiire.com.au ABN 55 050 029 635

Designed
M.W
Authorised
S.R

Checked
T.S
Date
13-06-19

TRIJENA STAGE 6 RESERVE SURFACE AND FINISHES PLAN

HUME CITY COUNCIL
PGG (MICKLEHAM) PTY LTD

PRELIMINARY Drg No 304010LD500

Rev
D

file name: 304010 Reserve LD01.dwg, layout name: LD01, plotted by: Matthew Bradbury, file location: \\spire.com.au\united\data\30401000\landscape\product, plot date: 26/02/2020 10:17 AM, Sheet 6 of 15 Sheets

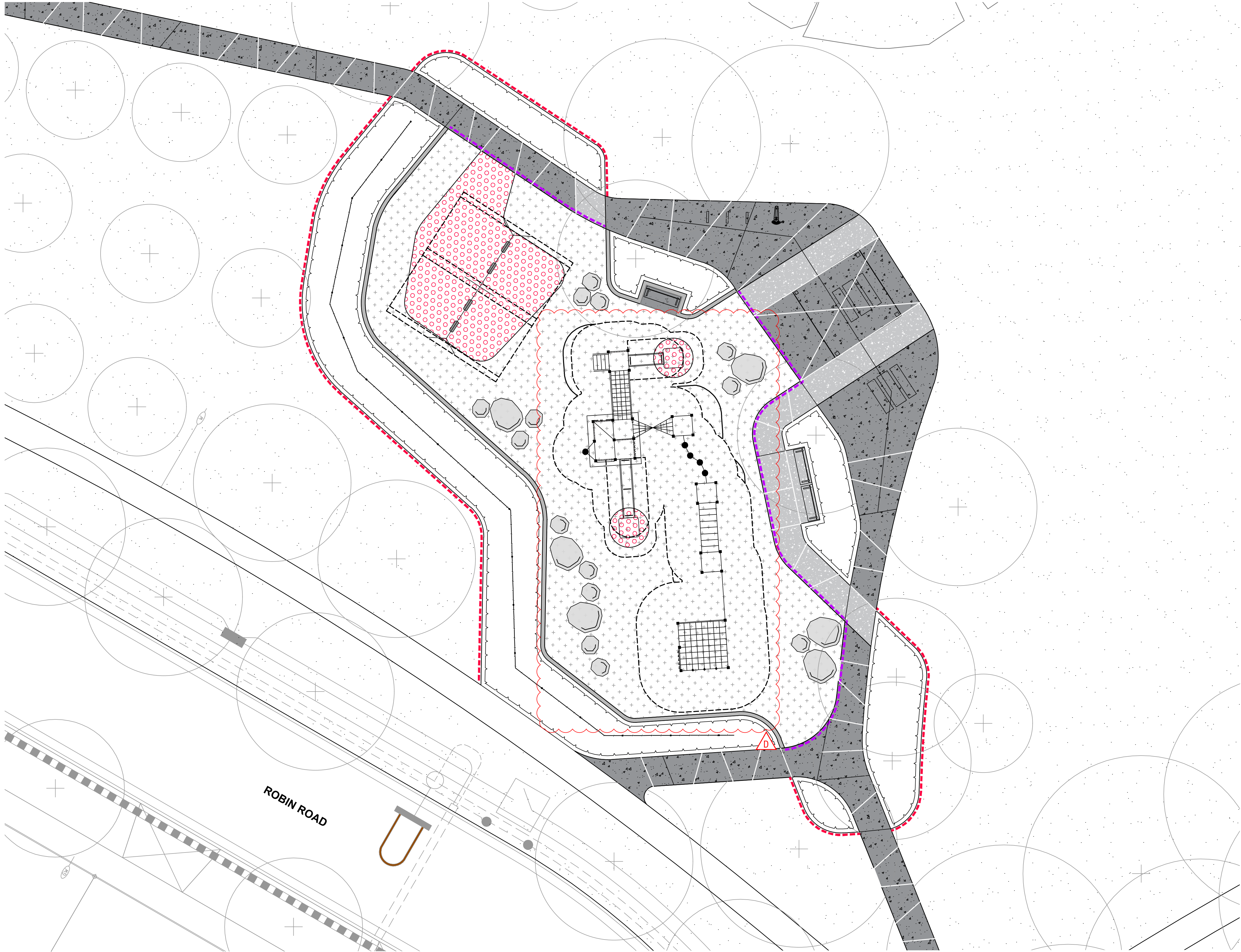

LEGEND

- Proposed Tree**
As scheduled, detailed and specified 1/LD902
- Turf Grass**
As scheduled, detailed and specified 3/LD902
- Proposed Garden Bed**
Refer to planting schedule 4/LD902
- Plain Grey Concrete**
As scheduled, detailed and specified 1/LD900
- Sand Blasted Concrete: Type 1**
As scheduled, detailed and specified 1/LD900
- Proposed Softfall Mulch**
As scheduled, detailed and specified 1/LD901
- Proposed Softfall Rubber**
As scheduled, detailed and specified 2/LD901
- Picnic Setting**
As scheduled, detailed and specified 1/LD906
- Shelter**
As scheduled, detailed and specified 1/LD907
- 1.5m Fall Zone / Circulation Space**
Shown around all climbable play objects
- Concrete Edge**
As detailed and specified 4/LD900
- Thickend Concrete Edge**
As detailed and specified 5/LD900
- Spade Edge**
As detailed and specified 7/LD900
- Fence**
As detailed and specified
- Expansion Joints**
As detailed and specified 3/LD900
- Saw Cuts**
As detailed and specified 3/LD900
- Seating**
As detailed and specified 1/LD906
- Boulders**
As detailed and specified 4/LD901
- Bike Rack**
As detailed and specified 1/LD905
- Water Fountain**
As detailed and specified 2/LD905
- Community Swing**
As detailed and specified 1/LD904
- Modular Rope Climbing Structure**
As detailed and specified 1/LD903

D	AMENDED IN ACCORDANCE WITH COUNCIL COMMENTS	MB	18-02-20	
C	AMENDED IN ACCORDANCE WITH COUNCIL COMMENTS	SR	23-07-19	
B	ISSUED FOR APPROVAL TO COUNCIL	S.R	13-06-19	
A	PRELIMINARY ISSUE	SR	12-06-19	
Rev	Amendments	Approved	Date	

H: 1:100
SCALE @ A1

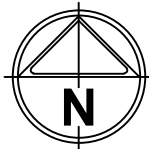

© Spiire Australia Pty Ltd All Rights Reserved
This document is produced by Spiire Australia Pty Ltd solely for the benefit of and use by the client in accordance with the terms of the retainer. Spiire Australia Pty Ltd does not and shall not assume any responsibility or liability whatsoever to any third party arising out of any use or reliance by third party on the content of this document.

spiire

414 La Trobe Street PO Box 16084 Melbourne
Victoria 8007 Australia T 61 3 9993 7888
spiire.com.au ABN 55 050 029 635

Designed
M.W
Authorised
S.R

Checked
T.S
Date
13-06-19

**TRIJENA
STAGE 6 RESERVE
DETAIL PLAN**

HUME CITY COUNCIL
PGG (MICKLEHAM) PTY LTD

PRELIMINARY Drg No **304010LD501**

Rev
D

file name: 304010 Reserve LD01.dwg, layout name: LD000, plotted by: Matthew Bradbury, file location: \\spire.com.au\united\au\pfa\304010\landscape\product\plot date 26/02/2020 10:17 AM Sheet 7 of 15 Sheets



LEGEND

- Proposed Tree
As scheduled, detailed and specified 1/LD902
- Tree to be retained
As scheduled, detailed and specified
- Tree to be removed
Refer Arborist's report
- Turf Grass
As scheduled, detailed and specified 3/LD902
- Proposed Garden Bed
As scheduled, detailed and specified 4/LD902
- Callistemon 'Kings Park Special' Planting
Refer to planting schedule
- Existing Underground Services
By others
- Street lights
By others
- Extent of Works

NOTE:
- REFER TO LD200 FOR TREE SCHEDULE
AND NORTHERN BOUNDARY PLANTING
SCHEDULE

D	AMENDED IN ACCORDANCE WITH COUNCIL COMMENTS	MB	18-02-20	
C	AMENDED IN ACCORDANCE WITH COUNCIL COMMENTS	SR	23-07-19	
B	ISSUED FOR APPROVAL TO COUNCIL	SR	13-06-19	
A	PRELIMINARY ISSUE	SR	12-06-19	
Rev	Amendments	Approved	Date	

H: 1:250
SCALE @ A1

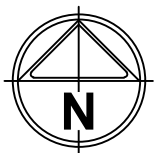

© Spiire Australia Pty Ltd All Rights Reserved
This document is produced by Spiire Australia Pty Ltd solely for the benefit of and use by the client in accordance with the terms of the retainer. Spiire Australia Pty Ltd does not and shall not assume any responsibility or liability whatsoever to any third party arising out of any use or reliance by third party on the content of this document.

spiire

414 La Trobe Street PO Box 16084 Melbourne
Victoria 8007 Australia T 61 3 9993 7888
spiire.com.au ABN 55 050 029 635

Designed
M.W
Authorised
S.R

Checked
T.S
Date
13-06-19

**TRIJENA
STAGE 6 RESERVE
PLANTING PLANS
TREE PLANTING PLAN
HUME CITY COUNCIL
PGG (MICKLEHAM) PTY LTD**

PRELIMINARY Drg No **304010LD700**

Rev
D

file name 304010 Reserve LD01.dwg layout name LD001 plotted by Matthew Bradbury
file location \\spiire.com.au\united\data\304010\landscape\product\plot date 26/02/2020 10:17 AM Sheet 8 of 15 Sheets



LEGEND

- Proposed Tree
As scheduled, detailed and specified 1/LD902
- Turf Grass
As scheduled, detailed and specified 3/LD902
- Concrete Edge
As detailed and specified 4/LD900
- Spade Edge
As detailed and specified 6/LD900
- Acacia acinacea
- Eremophila 'Silver Bells'
- Kniphofia 'Poco Red'
- Leucadendron 'Devils Bush'
- Lomandra 'long John Silver'
- Myoporum parvifolium
- Westringia fruticosa
- Sedum 'Autumn Joy'
- Cotyledon Orbiculata
- Stachys Byzantina 'Big Ears'
- Acacia Cognata 'Lime Light'
- Planting Code
Refer to planting schedule

NOTE:
- REFER TO DRAWING LD200 FOR PLANTING SCHEDULE

Rev	Amendments	Approved	Date
D	AMENDED IN ACCORDANCE WITH COUNCIL COMMENTS	MB	18-02-20
C	AMENDED IN ACCORDANCE WITH COUNCIL COMMENTS	SR	23-07-19
B	ISSUED FOR APPROVAL TO COUNCIL	S.R	13-06-19
A	PRELIMINARY ISSUE	SR	12-06-19

H: 1:100
SCALE @ A1

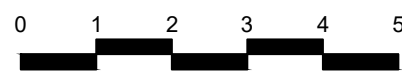

© Spiire Australia Pty Ltd All Rights Reserved
This document is produced by Spiire Australia Pty Ltd solely for the benefit of and use by the client in accordance with the terms of the retainer. Spiire Australia Pty Ltd does not and shall not assume any responsibility or liability whatsoever to any third party arising out of any use or reliance by third party on the content of this document.

spiire

414 La Trobe Street PO Box 16084 Melbourne
Victoria 8007 Australia T 61 3 9993 7888
spiire.com.au ABN 55 050 029 635

Designed
M.W
Authorised
S.R

Checked
T.S
Date
13-06-19

TRIJENA
STAGE 6 RESERVE
PLANTING PLANS
04 SHEET TITLE
HUME CITY COUNCIL
PGG (MICKLEHAM) PTY LTD

PRELIMINARY Drg No **304010LD701** Rev **D**

200

125

75

Minimum 1:100 Fall

125mm thick 32mpa sandblasted aggregate concrete with F72 reinforcement (30 cover, top). Finish as per specification.

75mm layer of Class 2 F.C.R. compacted to 95% M.M.D.D.

Site soil trimmed and compacted to 95% M.M.D.D.

1 SANDBLASTED CONCRETE TYPE 1 & TYPE 2 DETAIL

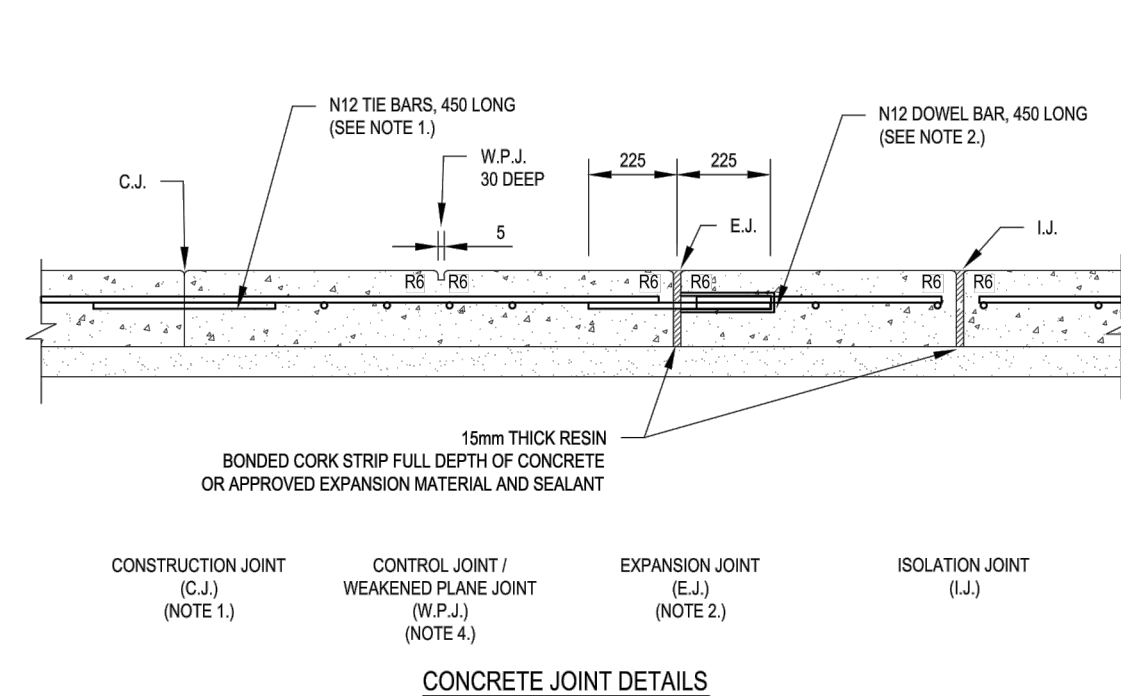

COUNCIL CONCRETE JOINTING DETAIL Scale 1:10 @ A1



D	AMENDED IN ACCORDANCE WITH COUNCIL COMMENTS	MB	18-02-20
C	AMENDED IN ACCORDANCE WITH COUNCIL COMMENTS	SR	23-07-19
B	ISSUED FOR APPROVAL TO COUNCIL	S.R	13-06-19
A	PRELIMINARY ISSUE	SR	12-06-19
Rev	Amendments	Approved	Date

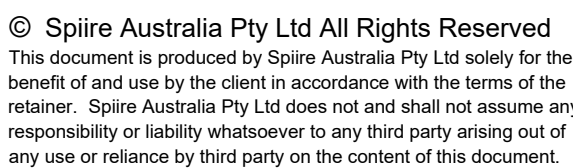

414 La Trobe Street PO Box 16084 Melbourne
Victoria 8007 Australia T 61 3 9993 7888
spiire.com.au ABN 55 050 029 635

Designed	Checked
M.W	T.S
Authorised	Date
S.R	13-06-19

TRIJENA
STAGE 6 RESERVE
DETAILS
DETAILS SHEET 1
HUME CITY COUNCIL
PGG (MICKLEHAM) PTY LTD

PRELIMINARY Drg No **304010LD900** Rev **D**

NOTE: Installation of Softfall mulch to be 400mm to allow for compaction.

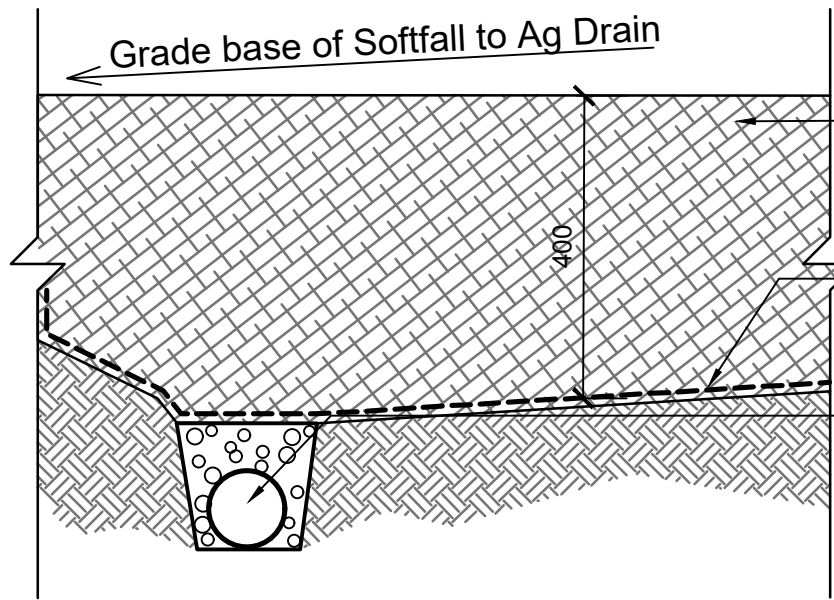

400mm min. depth consolidated softfall playground mulch. Taper at edges to meet concrete. Refer specification.

Geotextile fabric layer as specified.

Drainage pipe as specified, encased in polyester sock in 12mm screenings. Connected to existing stormwater. Contractor to ensure free sub-surface drainage. Refer specification.

1 **SOFTFALL MULCH DETAIL**
LD901 Scale 1:10 @ A1

NOTE: Rubber soft-fall surface thickness dependent on relative fall heights. to be constructed to manufacturer's detail it is the responsibility of the surfacing supplier to install the correct depth to provide for the equipment free heights of fall or required critical fall height ratings. All slopes to be rubberised are to be less than 45°.

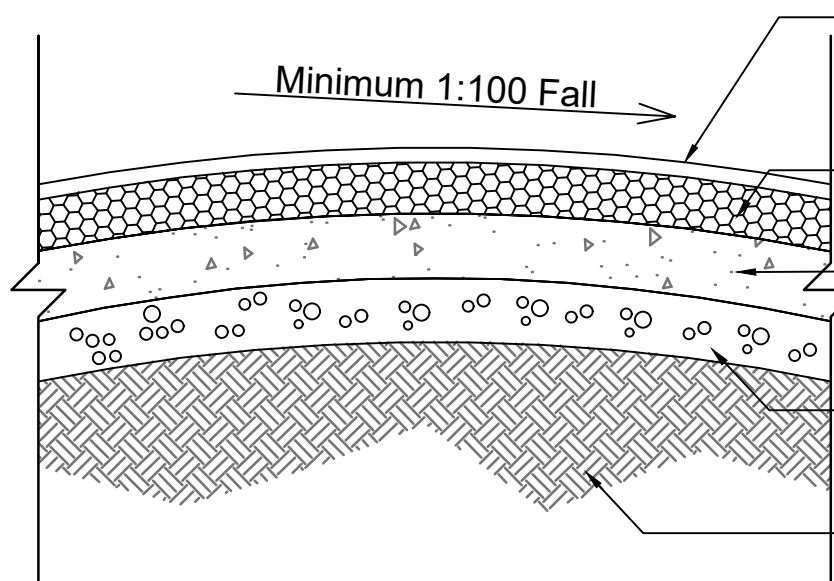

Ecolastic EPDM rubber granules, poured on-site as per manufacturer's specification. Refer Materials and Finishes schedule for colours.

Attenuation layer, pored on site as per manufacturers specifications.

Min 100mm thick 32mpa concrete with F82 reinforcement (min cover 50mm). Broom finish to concrete base to suppliers detail.

75mm layer of 20mm nom size Class 3 F.C.R. compacted to 95% M.M.D.D to engineer's detail.

Site soil trimmed & compacted to 95% M.M.D.D.

2 **SOFTFALL RUBBER DETAIL**
LD901 Scale 1:10 @ A1

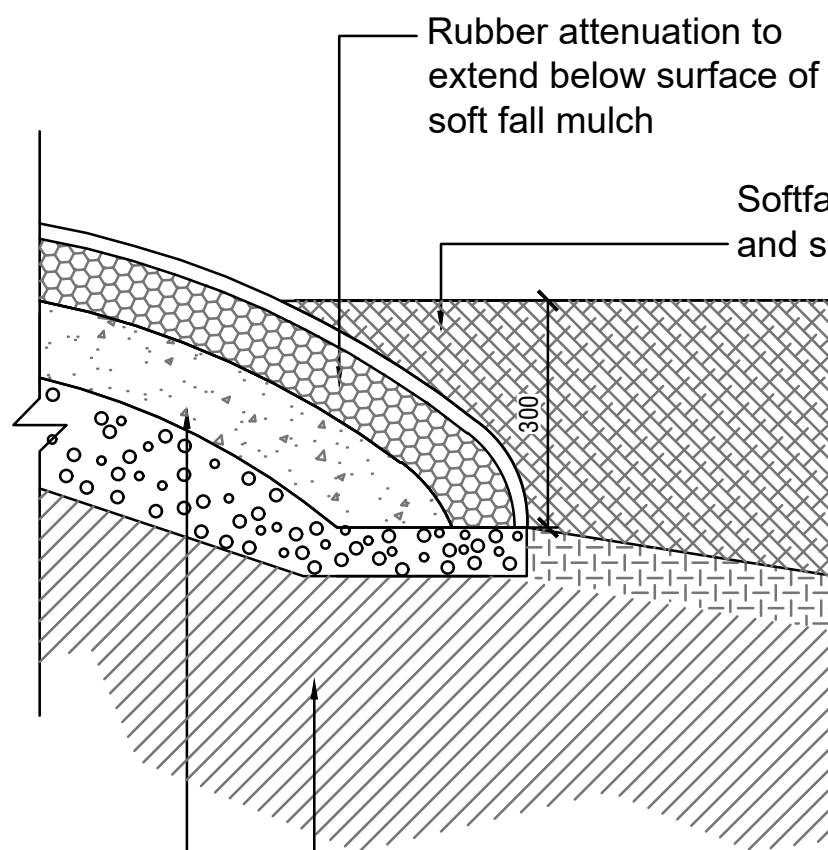

Rubber attenuation to extend below surface of soft fall mulch

Softfall Mulch, refer detail and specification.

300

Compacted subgrade. Refer Playground rubber surface detail, this page.

3 **SOFTFALL RUBBER / MULCH INTERFACE DETAIL**
LD901 Scale 1:10 @ A1

NOTE:

- Place rock with most visually interesting side facing up
- Set rock a minimum 1/2 below surrounding surface
- Ensure exposed rock face is free of sharp edges and safe to sit on
- Basalt boulders to be sourced locally.

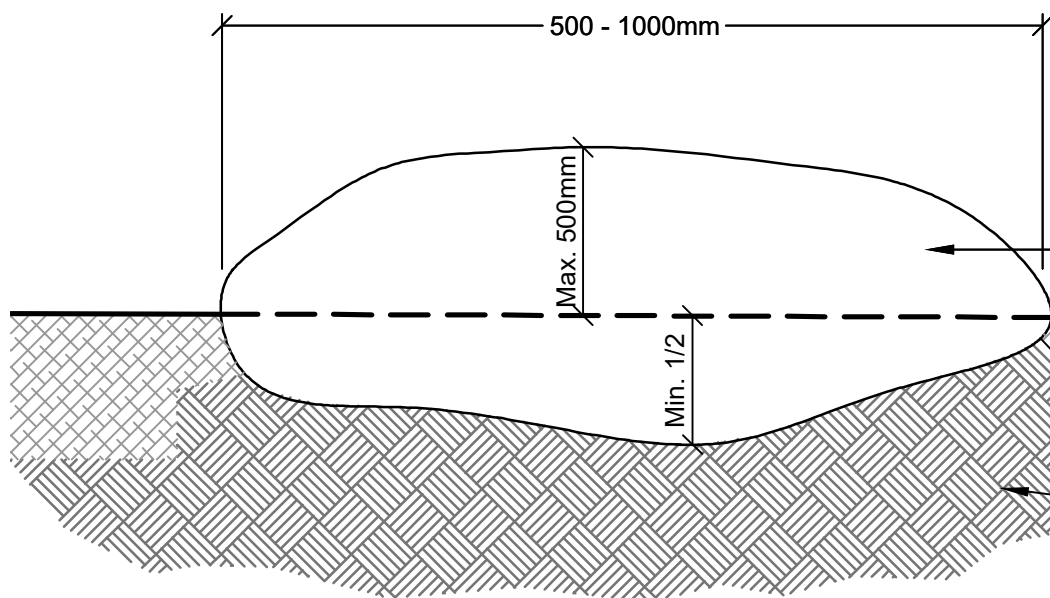

Basalt Rock - Min. 500mm Dia. Max. 1000 Dia.

Playground softfall mulch as detailed

Site soil trimmed and compacted to 95% M.M.D.D.

4 **BOULDER IN SOFTFALL**
LD901 Scale 1:10 @ A1

NOTE:

- Place rock with flattest and smoothest side facing up
- Set rock a minimum 1/2 below surrounding surface
- Ensure exposed rock face is free of sharp edges

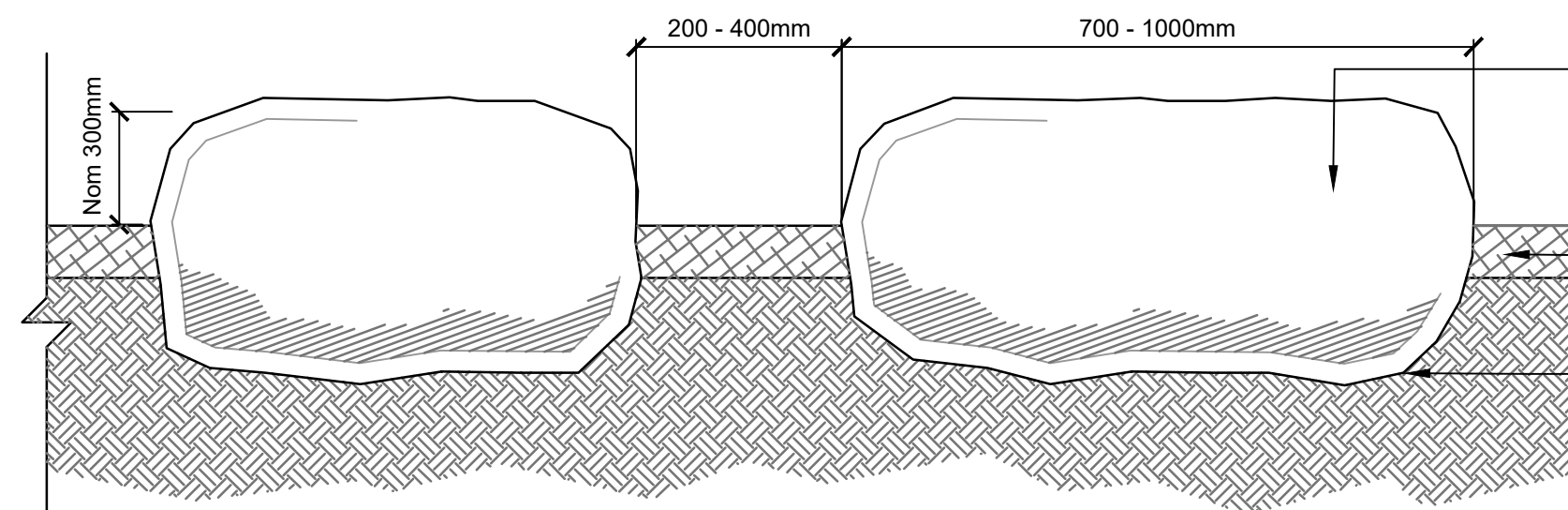

Basalt Rock - Min. 600mm Dia. Max. 1200 Dia. Set rock a minimum 1/2 below surrounding surface

75mm softfall mulch, as detailed and specified

Site soil trimmed and compacted to 95% M.M.D.D.

5 **ROCK STEPPER IN SOFTFALL**
LD901 Scale 1:10 @ A1

AS SHOWN



© Spiire Australia Pty Ltd All Rights Reserved
This document is produced by Spiire Australia Pty Ltd solely for the benefit of and use by the client in accordance with the terms of the retainer. Spiire Australia Pty Ltd does not and shall not assume any responsibility or liability whatsoever to any third party arising out of any use or reliance by third party on the content of this document.

spiire

414 La Trobe Street PO Box 16084 Melbourne
Victoria 8007 Australia T 61 3 9993 7888
spiire.com.au ABN 55 050 029 635

Designed
M.W
Authorised
S.R

Checked
T.S
Date
13-06-19

TRIJENA
STAGE 6 RESERVE
DETAILS
DETAILS SHEET 2
HUME CITY COUNCIL
PGG (MICKLEHAM) PTY LTD

PRELIMINARY Drg No **304010LD901** Rev **D**

NOTE:
- REFER TO DRAWING LD200 FOR PLANTING SCHEDULE

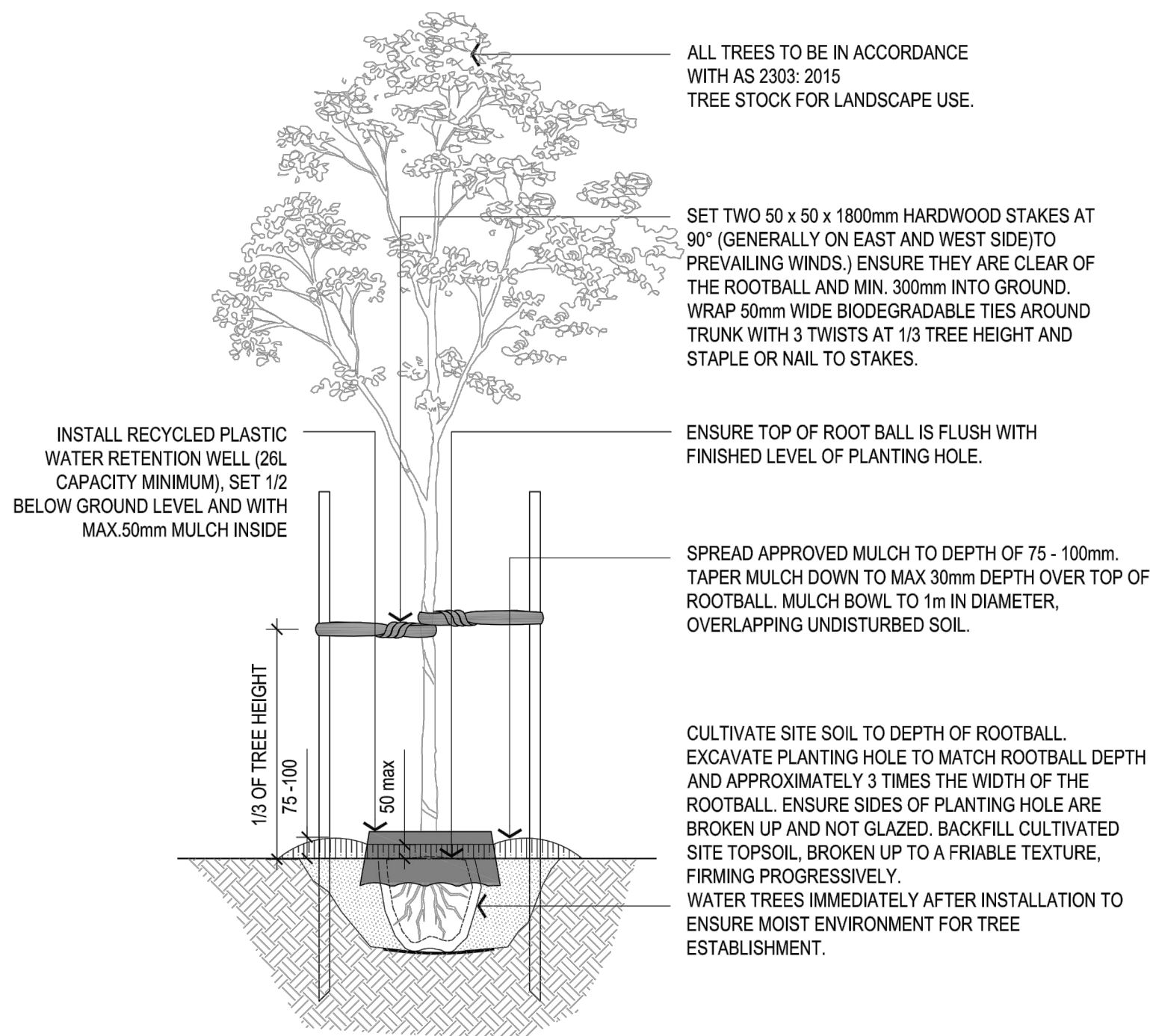

1 **TREE: SEMI-ADVANCED PLANTING DETAIL**
LD902 Scale 1:20 @ A1

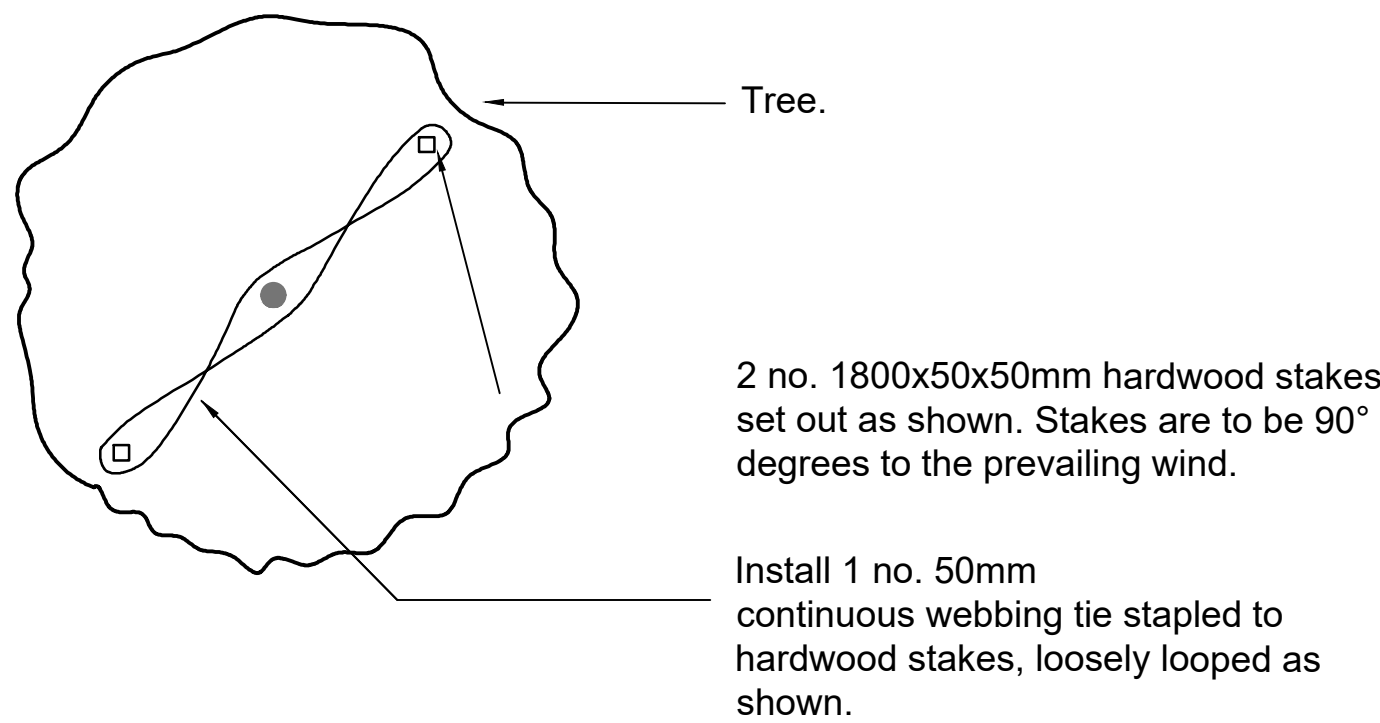

2 **TREE STAKE AND TIE DETAIL**
LD902 Scale 1:20 @ A1

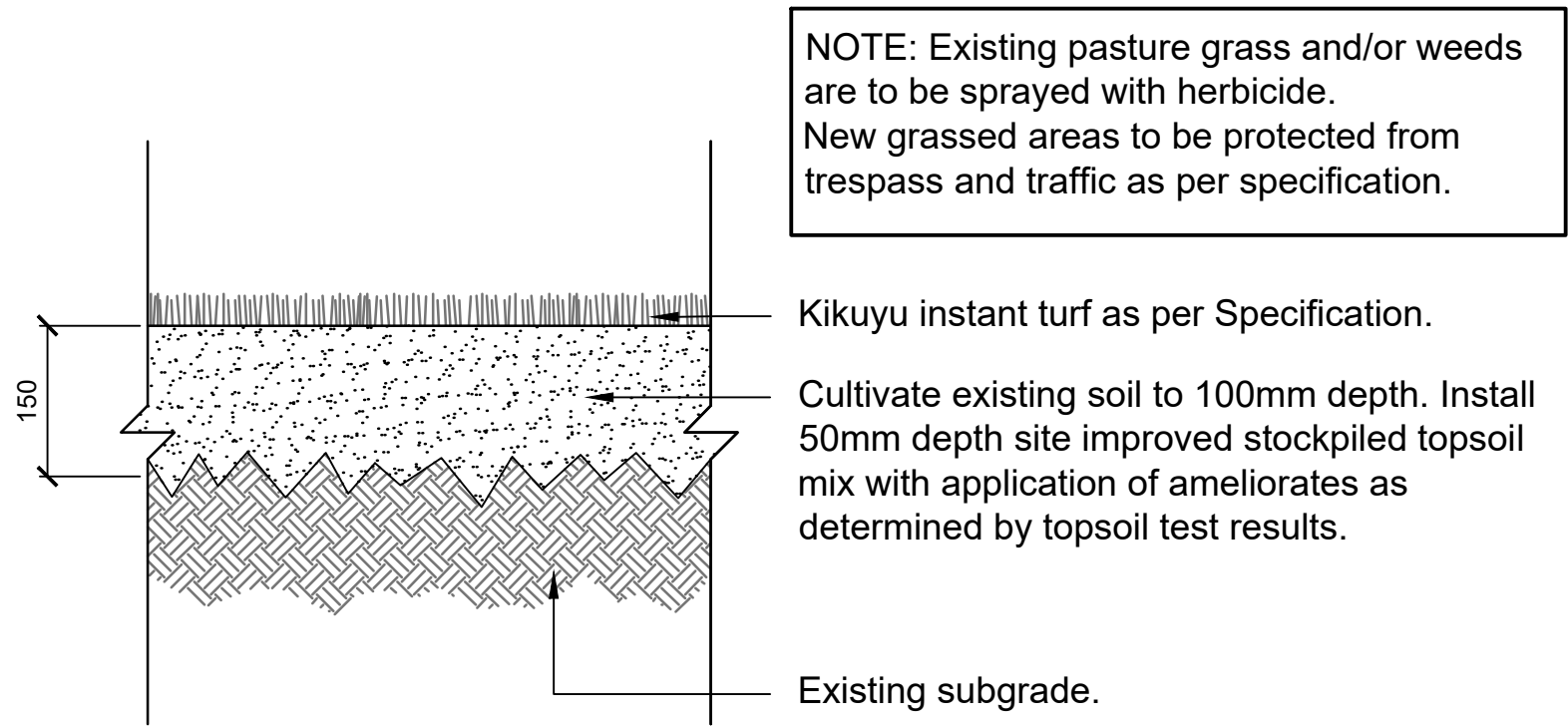

3 **TURF GRASS DETAIL**
LD902 Scale 1:10 @ A1

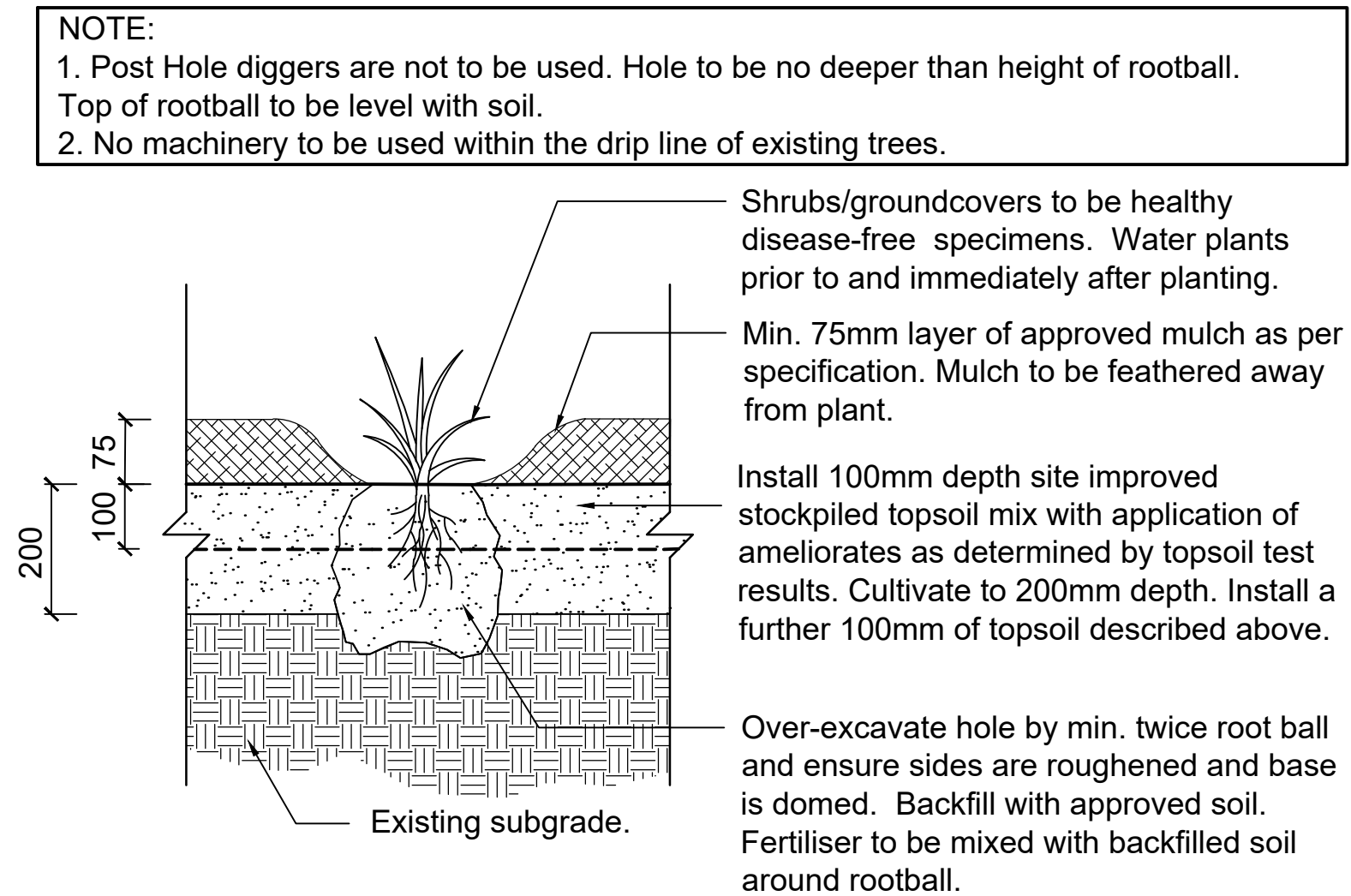

4 **SHRUB PLANTING DETAIL**
LD902 Scale 1:10 @ A1

file name 304010.Dwg Description LD01.dwg Layout name LD902 plotted by Matthew Bradbury file location \\spire.com.au\unpublished\LD902\304010.Landscape\product plot date 26/02/2020 10:18 AM Sheet 11 of 15 Sheets

Rev	Amendments	Approved	Date
A	PRELIMINARY ISSUE	SR	12-06-19
B	ISSUED FOR APPROVAL TO COUNCIL	S.R	13-06-19
C	AMENDED IN ACCORDANCE WITH COUNCIL COMMENTS	SR	23-07-19
D	AMENDED IN ACCORDANCE WITH COUNCIL COMMENTS	MB	18-02-20

AS SHOWN



© Spiire Australia Pty Ltd All Rights Reserved
This document is produced by Spiire Australia Pty Ltd solely for the benefit of and use by the client in accordance with the terms of the retainer. Spiire Australia Pty Ltd does not and shall not assume any responsibility or liability whatsoever to any third party arising out of any use or reliance by third party on the content of this document.

spiire

414 La Trobe Street PO Box 16084 Melbourne
Victoria 8007 Australia T 61 3 9993 7888
spiire.com.au ABN 55 050 029 635

Designed M.W	Checked T.S
Authorised S.R	Date 13-06-19

**TRIJENA
STAGE 6 RESERVE
DETAILS
DETAILS SHEET 3**
HUME CITY COUNCIL
PGG (MICKLEHAM) PTY LTD

PRELIMINARY Drg No **304010LD902** Rev **D**

NOTE:
- REFER TO MANUFACTURERS DETAILS & SPECIFICATIONS FOR INSTALLATION.



1 SPECTRUM+ COMMUNITY SWING
LD903 Scale 1:50@ A1

file name 304010 Reserve LD01.dwg, layout name LD003, plotted by Matthew Bradbury, file location \\spiire.com.au\mtd\projects\304010\landscape\product\plot date 26/02/2020 10:18 AM Sheet 12 of 15 Sheets

D	AMENDED IN ACCORDANCE WITH COUNCIL COMMENTS	MB	18-02-20
C	AMENDED IN ACCORDANCE WITH COUNCIL COMMENTS	SR	23-07-19
B	ISSUED FOR APPROVAL TO COUNCIL	S.R	13-06-19
A	PRELIMINARY ISSUE	SR	12-06-19
Rev	Amendments	Approved	Date

AS SHOWN

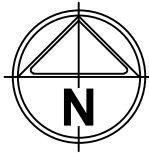

© Spiire Australia Pty Ltd All Rights Reserved
This document is produced by Spiire Australia Pty Ltd solely for the benefit of and use by the client in accordance with the terms of the retainer. Spiire Australia Pty Ltd does not and shall not assume any responsibility or liability whatsoever to any third party arising out of any use or reliance by third party on the content of this document.

spiire

414 La Trobe Street PO Box 16084 Melbourne
Victoria 8007 Australia T 61 3 9993 7888
spiire.com.au ABN 55 050 029 635

Designed
M.W
Authorised
S.R

Checked
T.S
Date
13-06-19

**TRIJENA
STAGE 6 RESERVE
DETAILS
DETAILS SHEET 4
HUME CITY COUNCIL
PGG (MICKLEHAM) PTY LTD**

PRELIMINARY Drg No 304010LD903

Rev
D

NOTE:
- REFER TO MANUFACTURERS DETAILS & SPECIFICATIONS FOR INSTALLATION.

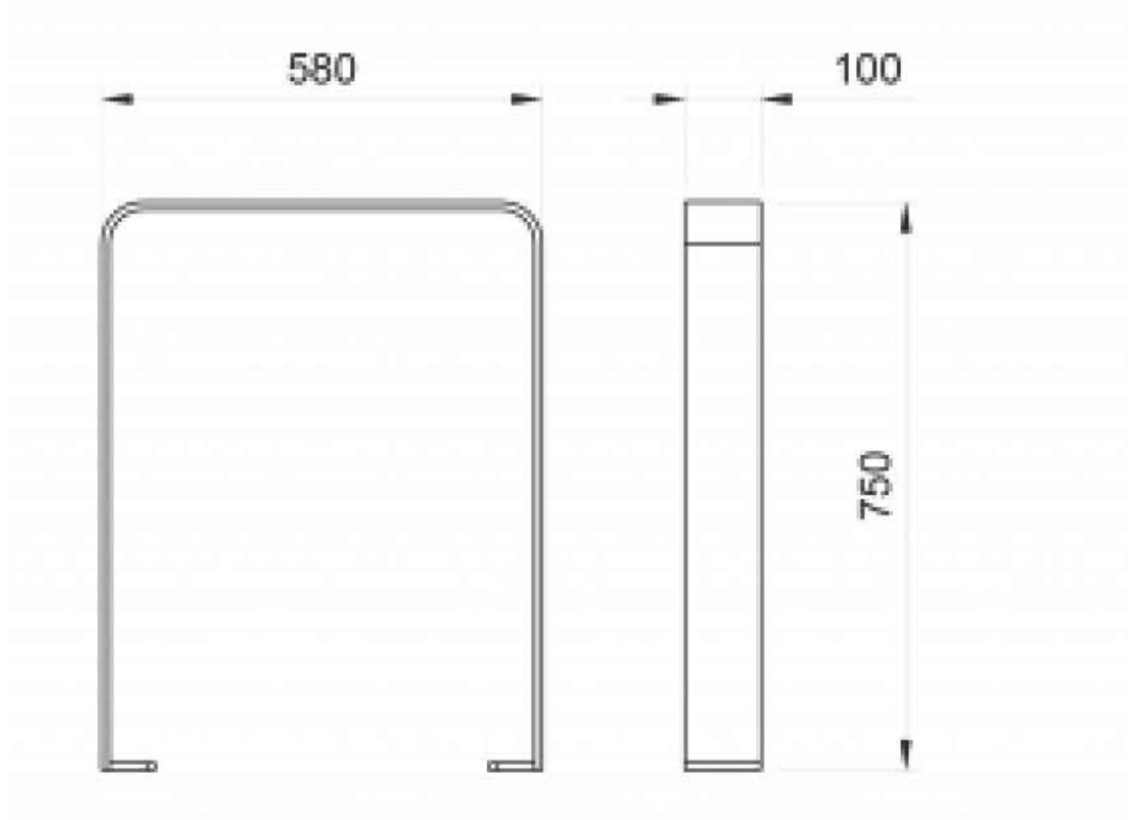

1

LD904

COMMERCIAL SYSTEMS URBANIA BIKE RACK

Scale 1:10@ A1

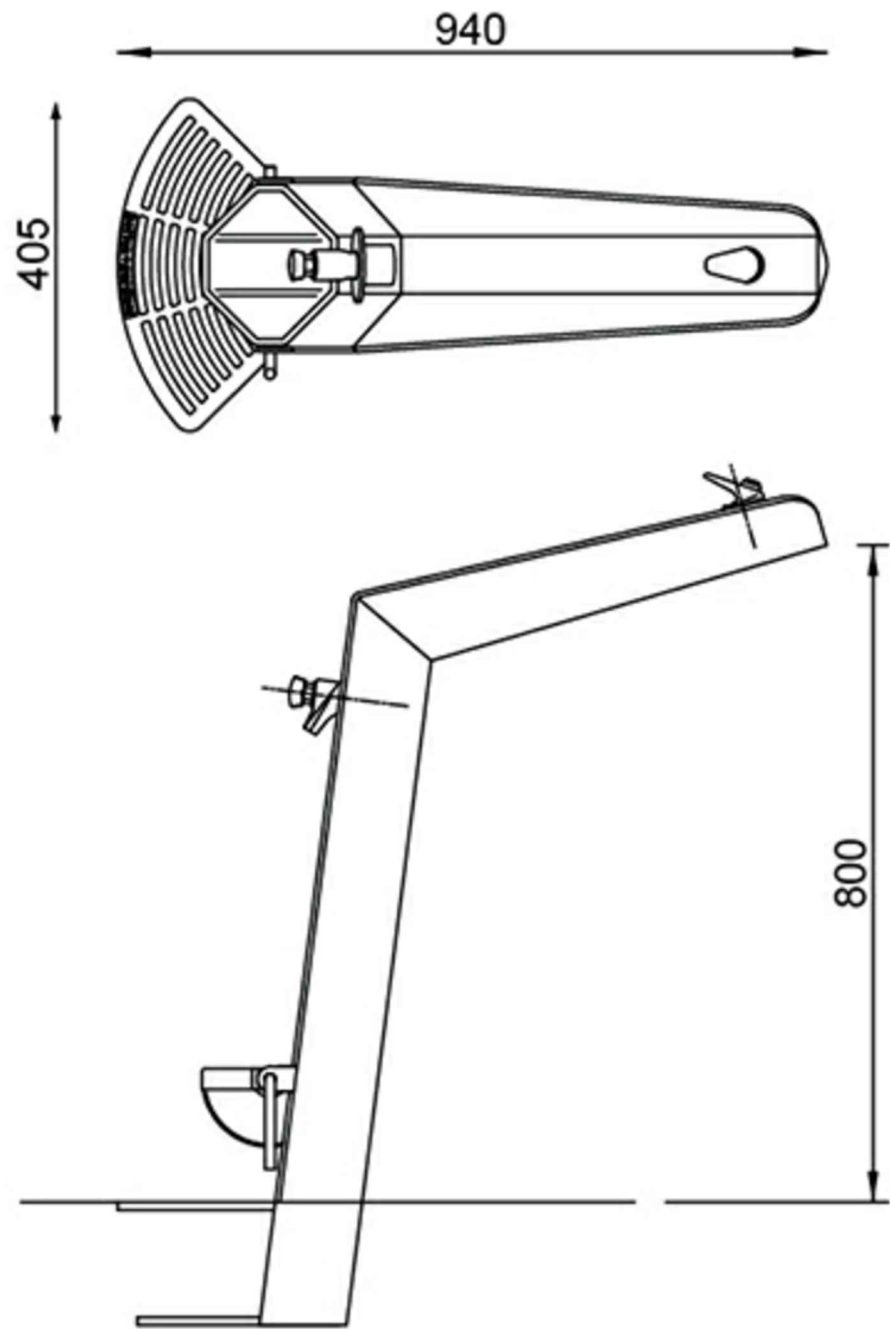

2

LD904

PROSPECT DRINKING FOUNTAIN WITH DOG BOWL AND BOTTLE TAP

Scale 1:10@ A1

file name 304010 Reserve LD904.dwg layout name LD904 created by Matthew Bradbury
file location \\spire.com.au\united\au\staff\304010\landscape\product\plot date 26/02/2020 10:18 AM Sheet 13 of 15 Sheets

D	AMENDED IN ACCORDANCE WITH COUNCIL COMMENTS	MB	18-02-20
C	AMENDED IN ACCORDANCE WITH COUNCIL COMMENTS	SR	23-07-19
B	ISSUED FOR APPROVAL TO COUNCIL	S.R	13-06-19
A	PRELIMINARY ISSUE	SR	12-06-19
Rev	Amendments	Approved	Date

AS SHOWN



© Spiire Australia Pty Ltd All Rights Reserved
This document is produced by Spiire Australia Pty Ltd solely for the benefit of and use by the client in accordance with the terms of the retainer. Spiire Australia Pty Ltd does not and shall not assume any responsibility or liability whatsoever to any third party arising out of any use or reliance by third party on the content of this document.



414 La Trobe Street PO Box 16084 Melbourne
Victoria 8007 Australia T 61 3 9993 7888
spiire.com.au ABN 55 050 029 635

Designed
M.W
Authorised
S.R

Checked
T.S
Date
13-06-19

TRIJENA
STAGE 6 RESERVE
DETAILS
DETAILS SHEET 5
HUME CITY COUNCIL
PGG (MICKLEHAM) PTY LTD

PRELIMINARY Drg No 304010LD904

Rev
D

NOTE:
- REFER TO MANUFACTURERS DETAILS & SPECIFICATIONS FOR INSTALLATION.

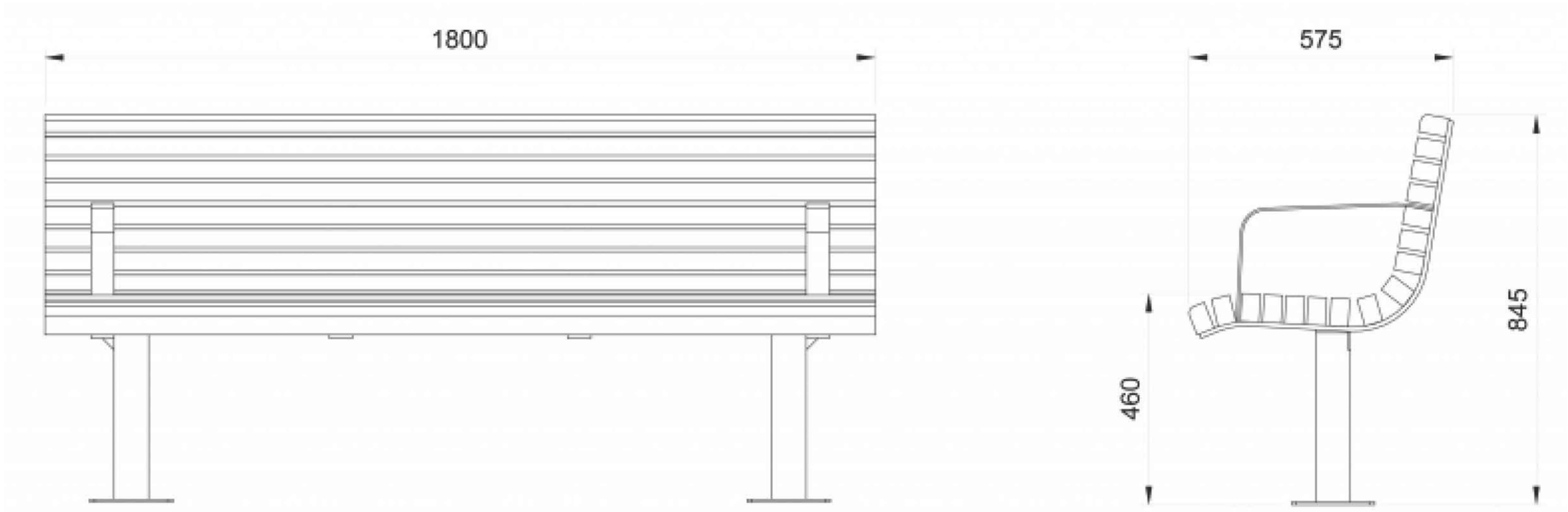

1 **COMMERCIAL SYSTEMS VERTICAL SLAT SEAT DETAIL**
LD905 Scale 1:10@ A1

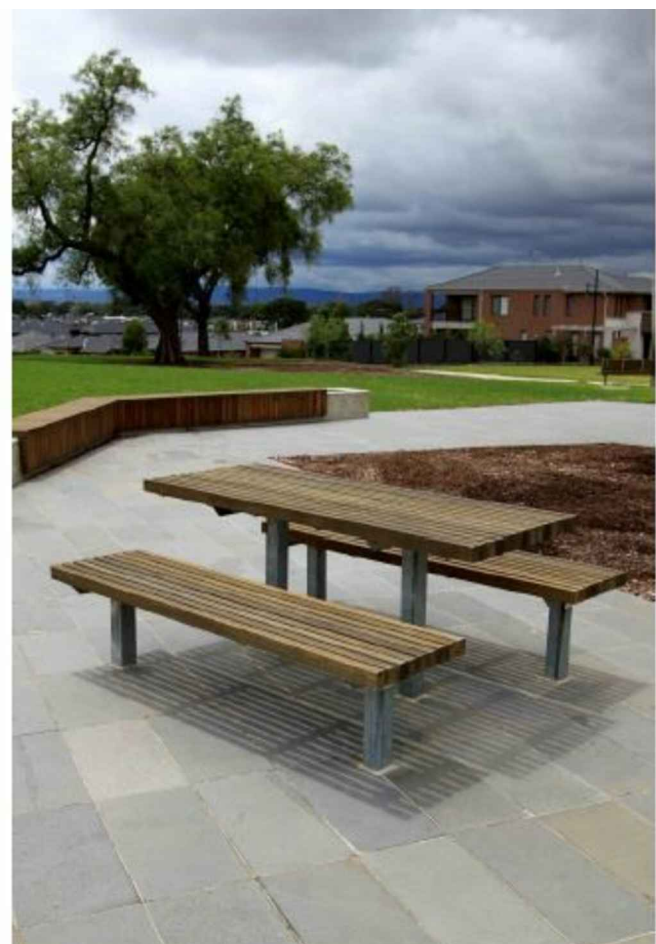
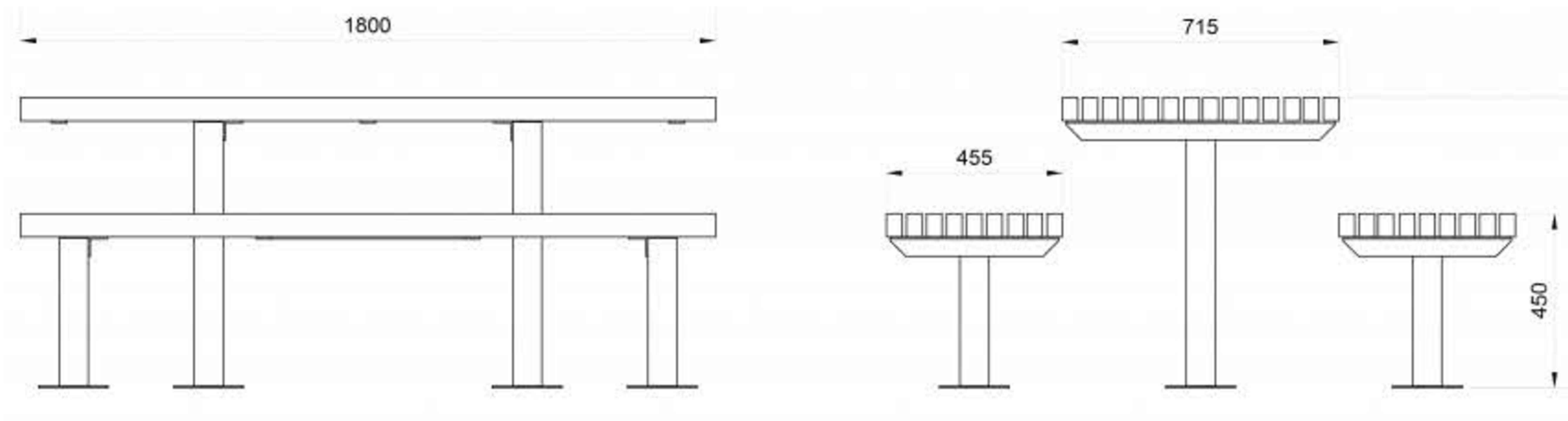

2 **COMMERCIAL SYSTEMS VERTICAL SLAT SETTING DETAIL**
LD905 Scale 1:10@ A1

file name: 304010 Reserve LD01.dwg, layout name: LD905, plotted by: Matthew Bradbury, file location: \\spiire.com.au\united\data\LD905\30401000\landscape\product\plot date: 26/02/2020 10:18 AM Sheet: 14 of 15 Sheets

D	AMENDED IN ACCORDANCE WITH COUNCIL COMMENTS	MB	18-02-20
C	AMENDED IN ACCORDANCE WITH COUNCIL COMMENTS	SR	23-07-19
B	ISSUED FOR APPROVAL TO COUNCIL	S.R	13-06-19
A	PRELIMINARY ISSUE	SR	12-06-19
Rev	Amendments	Approved	Date

AS SHOWN



© Spiire Australia Pty Ltd All Rights Reserved
This document is produced by Spiire Australia Pty Ltd solely for the benefit of and use by the client in accordance with the terms of the retainer. Spiire Australia Pty Ltd does not and shall not assume any responsibility or liability whatsoever to any third party arising out of any use or reliance by third party on the content of this document.

spiire

414 La Trobe Street PO Box 16084 Melbourne
Victoria 8007 Australia T 61 3 9993 7888
spiire.com.au ABN 55 050 029 635

Designed
M.W
Authorised
S.R

Checked
T.S
Date
13-06-19

**TRIJENA
STAGE 6 RESERVE
DETAILS
DETAILS SHEET 6
HUME CITY COUNCIL
PGG (MICKLEHAM) PTY LTD**

PRELIMINARY Drg No 304010LD905

Rev
D

NOTE:
- REFER TO MANUFACTURERS DETAILS & SPECIFICATIONS FOR INSTALLATION.

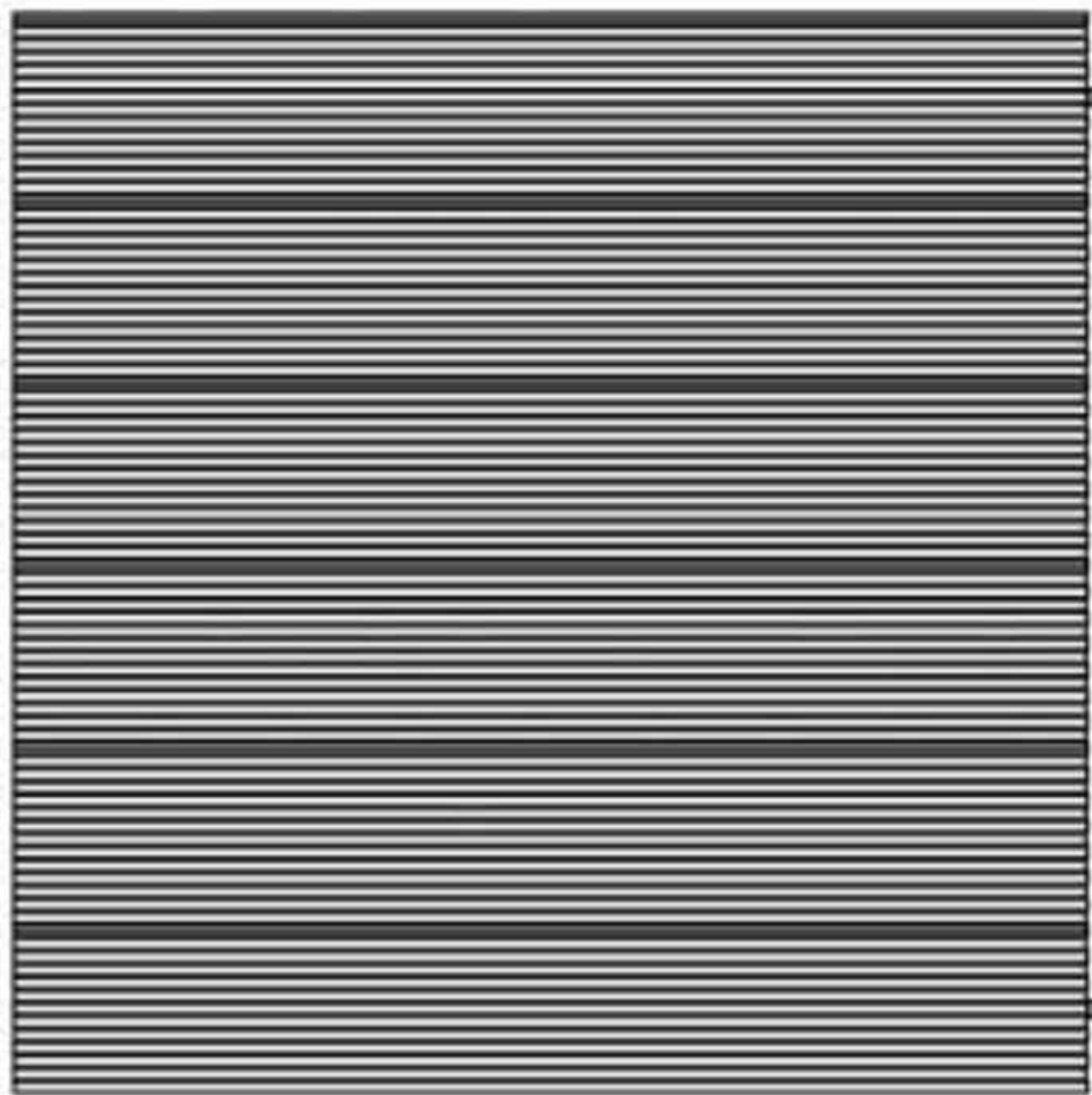

Top view

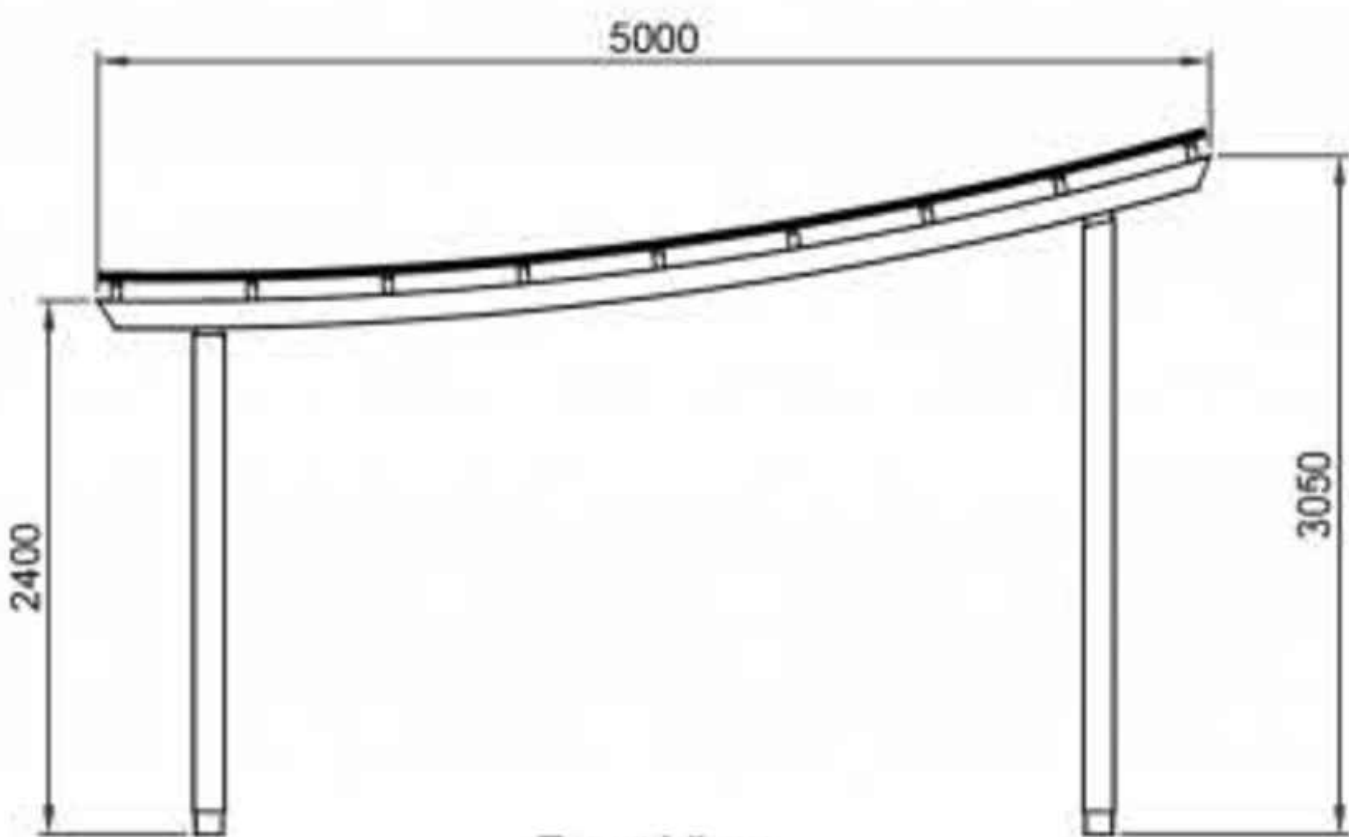

Front View

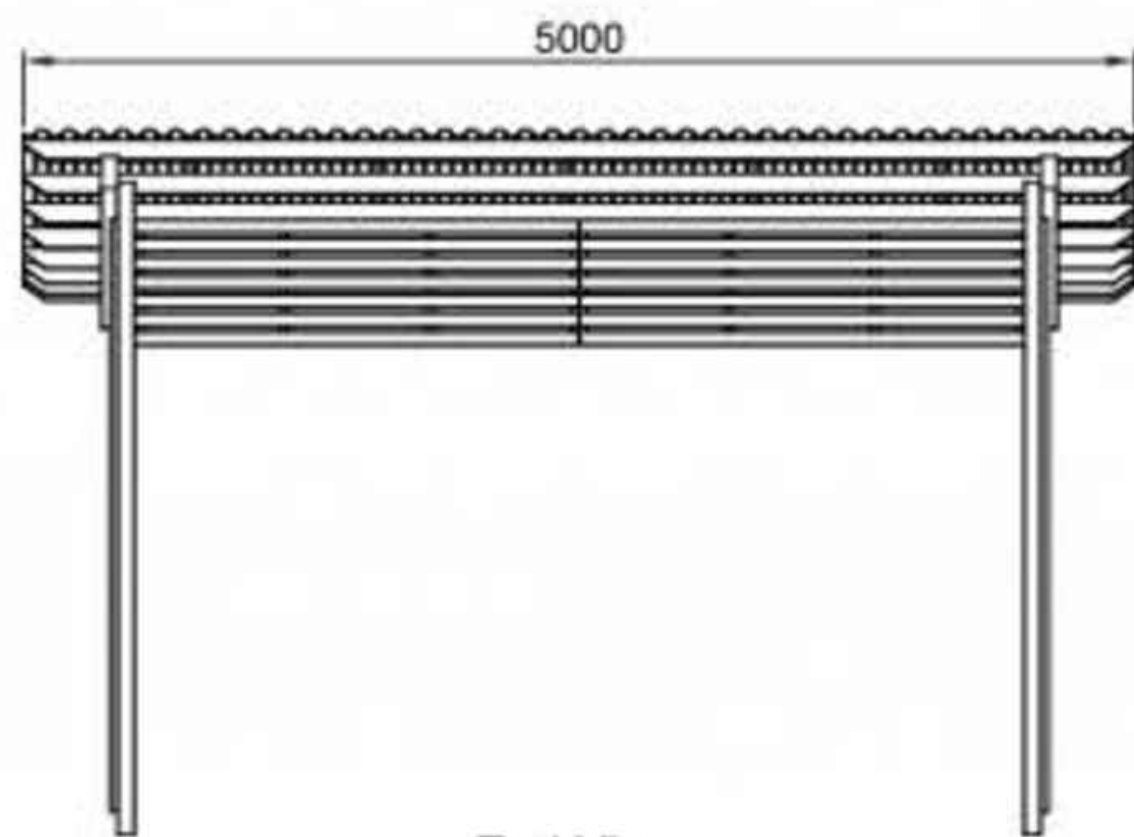

End View



1 COMMERCIAL SYSTEMS NORTH SHELTER TYPICAL DETAIL
LD906 Scale 1:100@ A1

AS SHOWN



© Spiire Australia Pty Ltd All Rights Reserved
This document is produced by Spiire Australia Pty Ltd solely for the benefit of and use by the client in accordance with the terms of the retainer. Spiire Australia Pty Ltd does not and shall not assume any responsibility or liability whatsoever to any third party arising out of any use or reliance by third party on the content of this document.

spiire

414 La Trobe Street PO Box 16084 Melbourne
Victoria 8007 Australia T 61 3 9993 7888
spiire.com.au ABN 55 050 029 635

Designed
M.W
Authorised
S.R

Checked
T.S
Date
13-06-19

TRIJENA
STAGE 6 RESERVE
DETAILS
DETAILS SHEET 7
HUME CITY COUNCIL
PGG (MICKLEHAM) PTY LTD

PRELIMINARY Drg No 304010LD906 Rev

D

file name 304010 Reserve LD01.dwg layout name LD906 plotted by Matthew Bradbury
file location \\spiire.com.au\united\data\304010\landscape\product\plot date 26/02/2020 10:18 AM Sheet 15 of 15 Sheets