

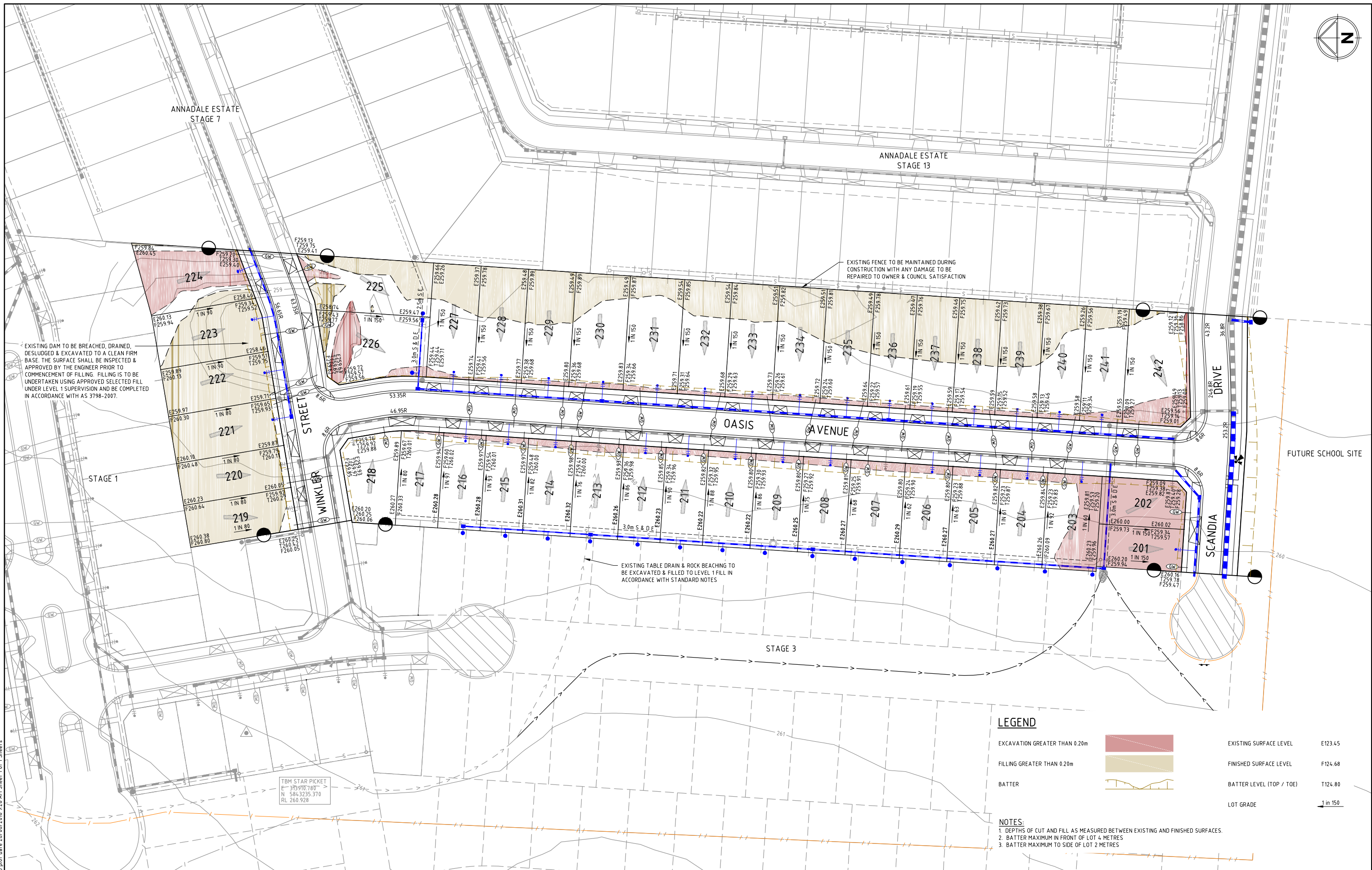

ANNADALE ESTATE
STAGE 7

ANNADALE ESTATE
STAGE 13



LEGEND

- EXCAVATION GREATER THAN 0.20m
- FILLING GREATER THAN 0.20m
- BATTER
- EXISTING SURFACE LEVEL E123.45
- FINISHED SURFACE LEVEL F124.68
- BATTER LEVEL (TOP / TOE) T124.80
- LOT GRADE 1 in 150

- NOTES:**
1. DEPTHS OF CUT AND FILL AS MEASURED BETWEEN EXISTING AND FINISHED SURFACES.
 2. BATTER MAXIMUM IN FRONT OF LOT 4 METRES
 3. BATTER MAXIMUM TO SIDE OF LOT 2 METRES

TBM STAR PICKET
E 373.910 780
N 594.325 370
RL 260.928

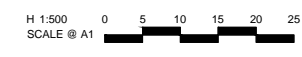

© Spiire Australia Pty Ltd All Rights Reserved
This document is produced by Spiire Australia Pty Ltd solely for the benefit of and use by the client in accordance with the terms of the retainer. Spiire Australia Pty Ltd does not and shall not assume any responsibility or liability whatsoever to any third party arising out of any use or reliance by third party on the content of this document.



469 La Trobe Street PO Box 16084 Melbourne
Victoria 8007 Australia T 61 3 9993 7888
spiire.com.au ABN 55 050 029 635



Designed
M.SHIRLEY
Authorised
M.LETSON



Checked
J.POYNER
Date
19-07-17

**TRIJENA
STAGE 2
GENERAL
SALES PLAN**
HUME CITY COUNCIL
PGG (MICKLEHAM) PTY LTD

CONSTRUCTION Drg No 304006CG100 Rev 0

file name 304006CG100.dwg layout name CG100 plotted by Joshua Poyner
file location C:\304006CG100\CAD\plot_date 26/06/2018 9:28 AM Sheet 1 of 1 Sheets

Rev	Amendments	Approved	Date
0	ISSUED FOR CONSTRUCTION	M.L.	26-06-18
C	GENERAL REVISION	M.L.	10-10-17
B	GENERAL REVISION	M.L.	02-08-17
A	PRELIMINARY ISSUE	M.L.	19-07-17